



Brokerage

NAU
YACHTS

HAZE

MOTOR YACHT EXTRA YACHTS BY ISA 26M 2021

€4,300,000
FLAG - MALTA

MOTOR YACHT

HAZE



HAZE is a 26-meter motor yacht built by **Extra Yachts** in 2021, blending contemporary style, efficient performance, and award-winning interior design. Her sleek exterior was penned by Francesco Guida, while the refined interiors were crafted by Lawson Robb, with a focus on natural light, clean lines, and spatial fluidity. Expansive windows and a glazed salon ceiling create a strong visual connection to the sea, enhancing the sense of openness onboard.

Designed for relaxed cruising and entertaining, **HAZE** accommodates 8 guests in 4 well-appointed cabins, including a full-beam master suite, one VIP cabin, and two twin guest cabins. The crew area, separated for maximum privacy, includes 2 cabins for up to 4 crew. In 2021, **HAZE** was recognized with an interior design award for yachts under 40 meters, a testament to her exceptional style and layout.

Outdoor living is at the heart of the **HAZE** experience. A spacious beach club of approximately 50 sqm features a hydraulic swim platform, perfect for relaxing by the water. The flybridge offers sun loungers, a lounge area, and an exterior helm station. Solar panels integrated into the roof supplement onboard power, reflecting a commitment to energy efficiency.

Powered by twin Volvo Penta IPS 1350 engines, **HAZE** cruises comfortably at 12 knots, with a top speed of 21 knots and a range of up to 600 nautical miles. The shallow draft and balanced displacement contribute to her smooth performance, while the IPS system ensures easy handling and precise docking.

Whether for private use or charter, **HAZE** combines modern aesthetics, functionality, and sustainability — a distinctive and versatile yacht in the 26-meter segment.

[see more information about M/Y HAZE at www.nauyachts.com](http://www.nauyachts.com)

SPECIFICATION

SHIPYARD, MODEL	Extra Yachts by ISA 86
BUILT	2021
LENGTH	26 m
WATERLINE LENGTH	23 m
HULL CONFIGURATION	SEMI-DISPLACEMENT
BEAM	6.8 m
RANGE	600
DRAFT	1.8 m
GROSS TONNAGE	86 GT
YACHT CLASS	RINA
CABINS	4+2
MASTER CABIN	LOWER DECK
GUESTS	8
BERTHS	8+4
CREW	4
HEADS	5+2

EXTERIOR DESIGN	FRANCESCO GUIDA
INTERIOR DESIGN	LAWSON ROBB & FRANCESCO GUIDA
HULL	GRP
SUPERSTRUCTURE	GRP
ENGINES	2 x Volvo Penta IPS 1000 h.p.
TYPE OF DRIVE	VOLVO PENTA IPS
ENGINE HOURS	N/A
MAXIMUM SPEED	21 kn
CRUISING SPEED	12 kn
FUEL CONSUMPTION AT ECONOMICAL SPEED	~ 160 l/h
FUEL	7650 l
GREY WATER	500 l
BLACK WATER	500 l
FRESH WATER	1250 l
DISPLACEMENT	75

[see more information about M/Y HAZE at www.nauyachts.com](http://www.nauyachts.com)



EXTERIOR EXTRA YACHTS BY ISA 86 2021 MY
HAZE

M/Y HAZE



EXTERIOR EXTRA YACHTS BY ISA 86 2021 MY
HAZE

M/Y HAZE



EXTERIOR EXTRA YACHTS BY ISA 86 2021 MY
HAZE

M/Y HAZE



STARBOARD

M/Y HAZE



FLYBRIDGE

M/Y HAZE



SECONDARY HELM STATION

M/Y HAZE



COCKPIT SEATING AREA

M/Y HAZE



COCKPIT DINING AREA

M/Y HAZE



COCKPIT DINING AREA

M/Y HAZE



COCKPIT DINING AREA

M/Y HAZE



MAIN HELM STATION

M/Y HAZE



MAIN SALON

M/Y HAZE



MAIN SALON LOUNGE AREA

M/Y HAZE



MAIN SALON DINING AREA

M/Y HAZE



MASTER CABIN

M/Y HAZE



MASTER BATHROOM

M/Y HAZE



VIP CABIN

M/Y HAZE

General Arrangement



PROFILE

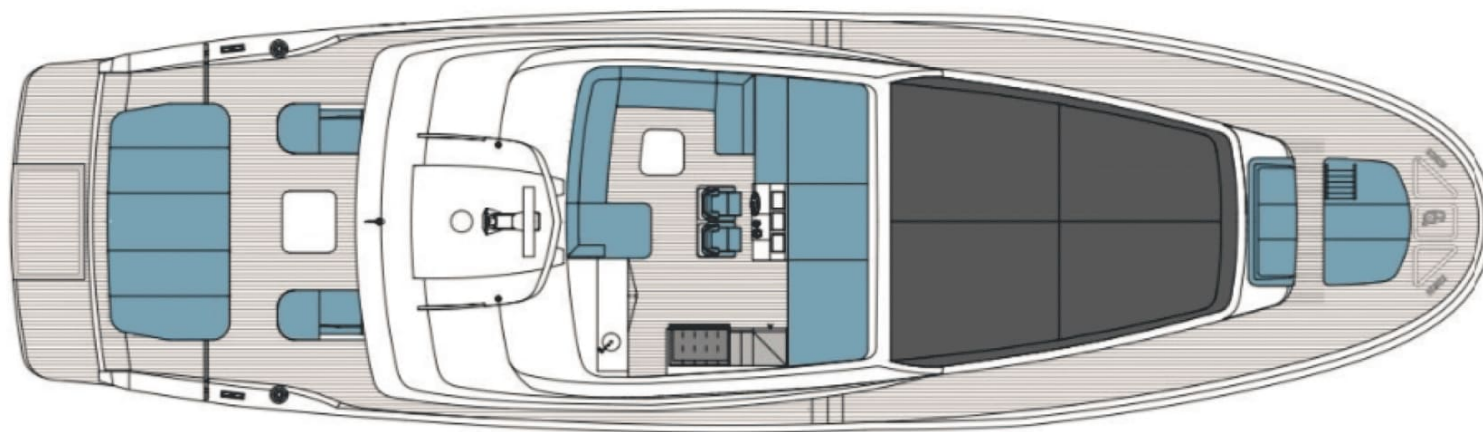

FLYBRIDGE

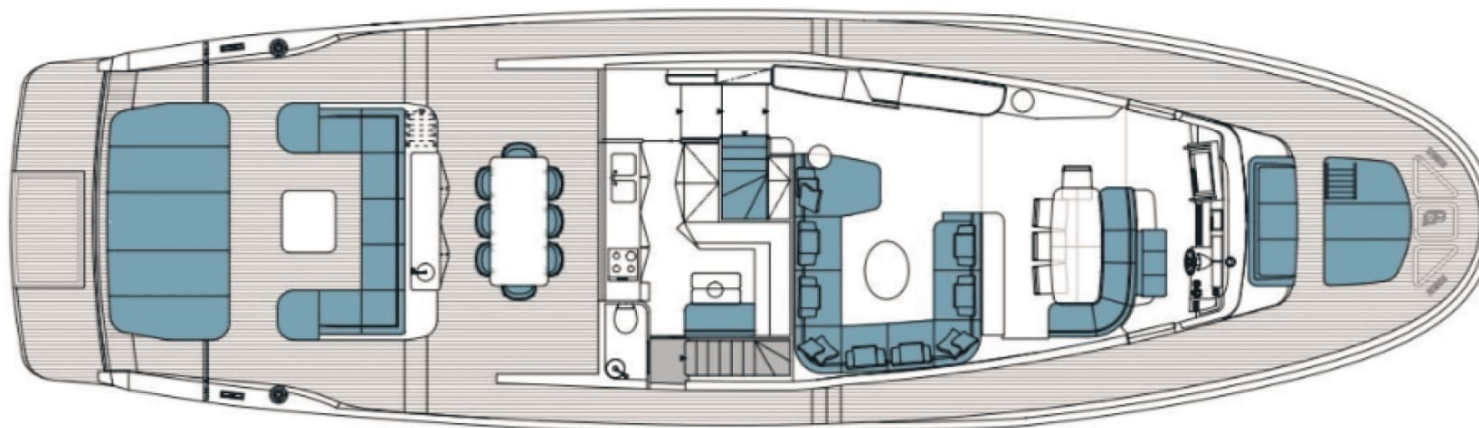

MAIN DECK

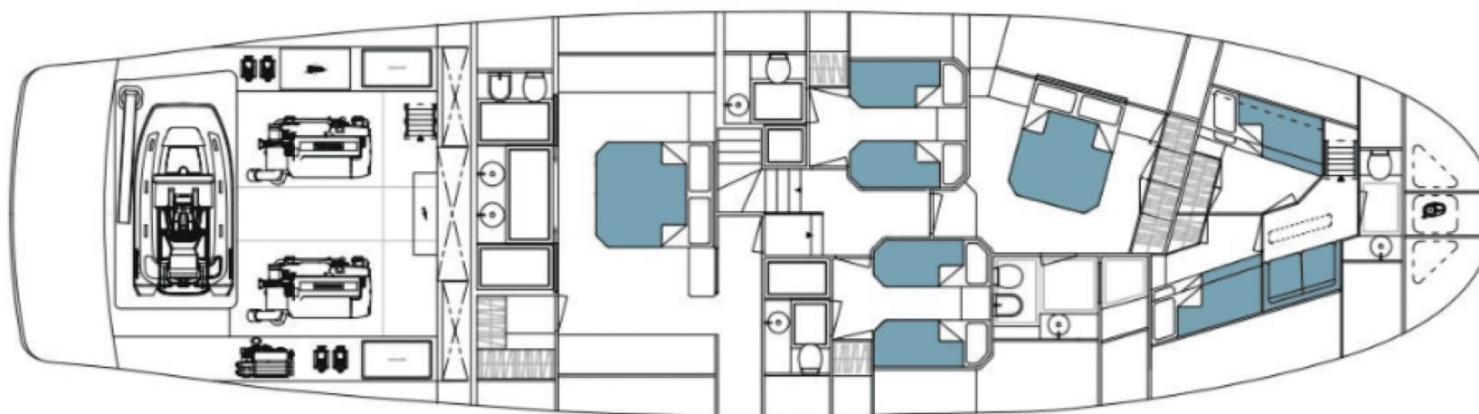

LOWER DECK



KIRILL KUATOV

+377 607 93 15 20

+39 333 576 44 44

 [Send e-mail](#)

 WhatsApp

 Telegram

[More information about M/Y HAZE at www.nauyachts.com](http://www.nauyachts.com)

[Watch video](#)