



Brokerage

**NAU**  
YACHTS

# SPEEDY BEAR

MOTOR YACHT RIVA 26.84M 2018

€4,950,000  
FLAG - MALTA

MOTOR YACHT

## SPEEDY BEAR

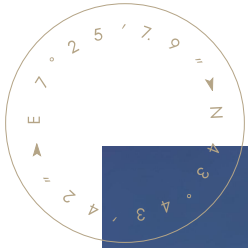

**SPEEDY BEAR** is a **Riva 88' Domino Super** delivered in 2018 and one of the final hulls built in this highly successful and now discontinued series. As Hull No. 37, she represents a rare opportunity to acquire one of the most sought-after modern **Riva** models, combining iconic Italian styling, exhilarating performance and exceptionally low engine hours.

Designed by Officina Italiana Design and built at the renowned **Ferretti Group** shipyards, the **88' Domino Super** remains one of the most recognisable sport yachts ever produced by **Riva**. Her metallic grey hull, sleek profile and distinctive sporting lines create an unmistakable presence on the water and continue to define the timeless appeal of the model.

Privately owned since new and never offered for charter, **SPEEDY BEAR** has benefited from attentive ownership and a consistently high standard of maintenance throughout her life. As a result, she is presented in outstanding condition and remains a particularly attractive example of the series.

Power comes from twin MTU 16V 2000 M96L engines, which have accumulated only approximately 557 hours. This figure is significantly below average for a yacht of her age and reflects limited private use and careful ownership. The low engine hours further enhance her appeal, making **SPEEDY BEAR** one of the most compelling opportunities currently available within the **Riva 88' Domino Super** market.

Combining the exclusivity of being one of the final hulls produced, the benefits of private ownership and the enduring prestige of the **Riva** brand, **SPEEDY BEAR** stands out as an exceptional example of one of Italy's most iconic modern sport yachts.

[see more information about M/Y SPEEDY BEAR at www.nauyachts.com](http://www.nauyachts.com)

# SPECIFICATION

SHIPYARD, MODEL	Riva 88 Domino Super
BUILT	2018
LENGTH	26.84 m
WATERLINE LENGTH	21.42 m
HULL CONFIGURATION	PLANING
BEAM	6.31 m
RANGE	320
DRAFT	2.02 m
GROSS TONNAGE	82 GT
YACHT CLASS	CE
CABINS	4+2
MASTER CABIN	LOWER DECK
GUESTS	8
BERTHS	8+4
CREW	4
HEADS	4+1

EXTERIOR DESIGN	OFFICINA ITALIANA DESIGN
INTERIOR DESIGN	OFFICINA ITALIANA DESIGN
HULL	GRP
SUPERSTRUCTURE	GRP
ENGINES	2 x MTU 16V 2000 M96L 2636 h.p.
TYPE OF DRIVE	SHAFT LINE
ENGINE HOURS	557 h
MAXIMUM SPEED	38 kn
CRUSING SPEED	34 kn
FUEL CONSUMPTION AT ECONOMICAL SPEED	~ 600 l/h
FUEL	7500 l
GREY WATER	400 l
BLACK WATER	450 l
FRESH WATER	1320 l
DISPLACEMENT	75.2

[see more information about M/Y SPEEDY BEAR at www.nauyachts.com](http://www.nauyachts.com)



EXTERIOR RIVA 88' DOMINO SUPER 2018 MY  
SPEEDY BEAR

M/Y SPEEDY BEAR



COCKPIT SEATING AREA

M/Y SPEEDY BEAR



PORT SIDE

M/Y SPEEDY BEAR



MAIN HELM STATION

M/Y SPEEDY BEAR



MAIN SALON LOUNGE AREA

M/Y SPEEDY BEAR



VIP CABIN

M/Y SPEEDY BEAR

# General Arrangement

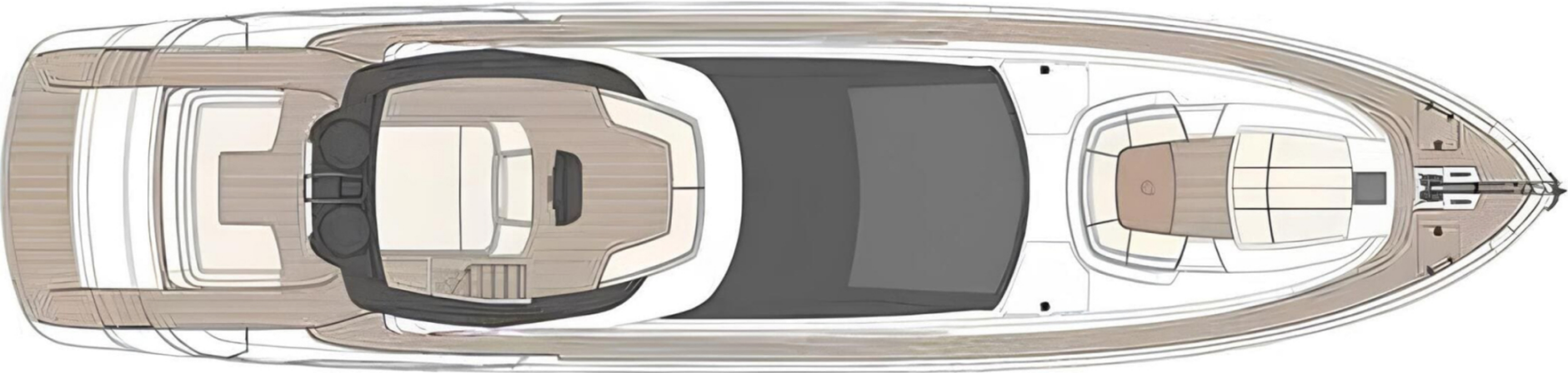

FLYBRIDGE

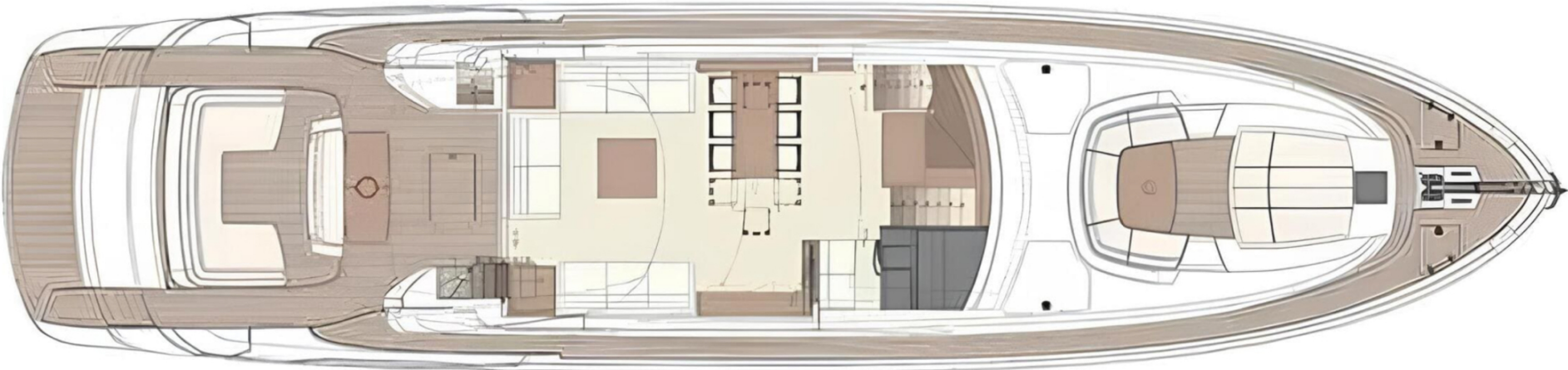

MAIN DECK



LOWER DECK



KRISTINA KRAM

+377 678 63 33 13

Send e-mail

WhatsApp

Telegram

[More information about M/Y SPEEDY BEAR at www.nauyachts.com](http://www.nauyachts.com)