



Brokerage

NAU
YACHTS

THYKE

MOTOR YACHT SANLORENZO 26.76M 2019

€4,450,000

FLAG - MALTA

MOTOR YACHT

THYKE



THYKE is a 26.76-metre motor yacht delivered in 2019 by **Sanlorenzo Yachts** as part of the highly regarded SL86 series. She combines contemporary Italian styling with a practical layout designed for comfortable private cruising and extended stays on board. Clean exterior lines, balanced proportions, and efficient use of space reflect the signature **Sanlorenzo** approach to modern yacht design.

Exterior living is organized around several key social areas. The flybridge features a dining area, lounge seating, bar, grill, and refrigerator, creating a versatile open-air environment. The aft cockpit connects directly to the main saloon, forming a seamless transition between interior and exterior spaces. Forward, the bow lounge includes a convertible table and sunbathing area. A hydraulic swim platform and integrated tender garage reinforce the open connection to the sea characteristic of **Sanlorenzo** models.

Accommodation is arranged for up to 8 guests across four en-suite staterooms. The full-beam master suite is positioned amidships and includes a walk-in wardrobe. A VIP cabin is located forward, alongside two twin guest cabins, one of which converts into a double. Crew accommodation for three is arranged separately in two cabins, ensuring privacy for guests.

Powered by twin MTU 12V2000M96L engines (1,947 hp each, approx. 1,000 hours), **THYKE** is equipped with hydraulic bow and stern thrusters, as well as an additional cockpit control station to simplify maneuvering. Zero Speed electric stabilizers reduce roll both underway and at anchor, significantly enhancing onboard comfort during extended stays.

Modern, functional, and easy to operate, **THYKE** offers a refined cruising platform that combines **Sanlorenzo's** distinctive design language with a highly practical onboard layout.

[see more information about M/Y THYKE at www.nauyachts.com](http://www.nauyachts.com)

SPECIFICATION

SHIPYARD, MODEL	Sanlorenzo SL86
BUILT	2019
LENGTH	26.76 m
WATERLINE LENGTH	22.43 m
HULL CONFIGURATION	PLANING
BEAM	6.35 m
RANGE	400
DRAFT	1.9 m
GROSS TONNAGE	81 GT
YACHT CLASS	RINA
CABINS	4+2
MASTER CABIN	LOWER DECK
GUESTS	8
BERTHS	8+3
CREW	3
HEADS	4+1

EXTERIOR DESIGN	OFFICINA ITALIANA DESIGN
INTERIOR DESIGN	OFFICINA ITALIANA DESIGN
HULL	GRP
SUPERSTRUCTURE	GRP
ENGINES	2 x MTU 12V 1947 h.p.
TYPE OF DRIVE	SHAFT LINE
ENGINE HOURS	1000 h
MAXIMUM SPEED	32 kn
CRUSING SPEED	26 kn
FUEL CONSUMPTION AT ECONOMICAL SPEED	~ 529 l/h
FUEL	8000 l
GREY WATER	400 l
BLACK WATER	400 l
FRESH WATER	1700 l
DISPLACEMENT	82

[see more information about M/Y THYKE at www.nauyachts.com](http://www.nauyachts.com)



EXTERIOR SANLORENZO SL86 2019 MY THYKE

M/Y THYKE



EXTERIOR SANLORENZO SL86 2019 MY THYKE

M/Y THYKE



EXTERIOR SANLORENZO SL86 2019 MY THYKE

M/Y THYKE



MAIN SALON LOUNGE AREA

M/Y THYKE



MAIN SALON DINING AREA

M/Y THYKE



MAIN SALON DINING AREA

M/Y THYKE



GALLEY

M/Y THYKE



GALLEY

M/Y THYKE



MAIN HELM STATION

M/Y THYKE



MASTER CABIN

M/Y THYKE



MASTER CABIN

M/Y THYKE



VIP CABIN

M/Y THYKE

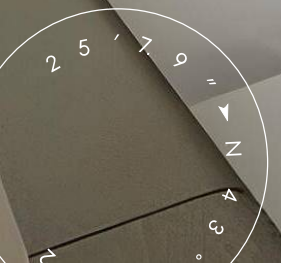

VIP CABIN

M/Y THYKE

General Arrangement

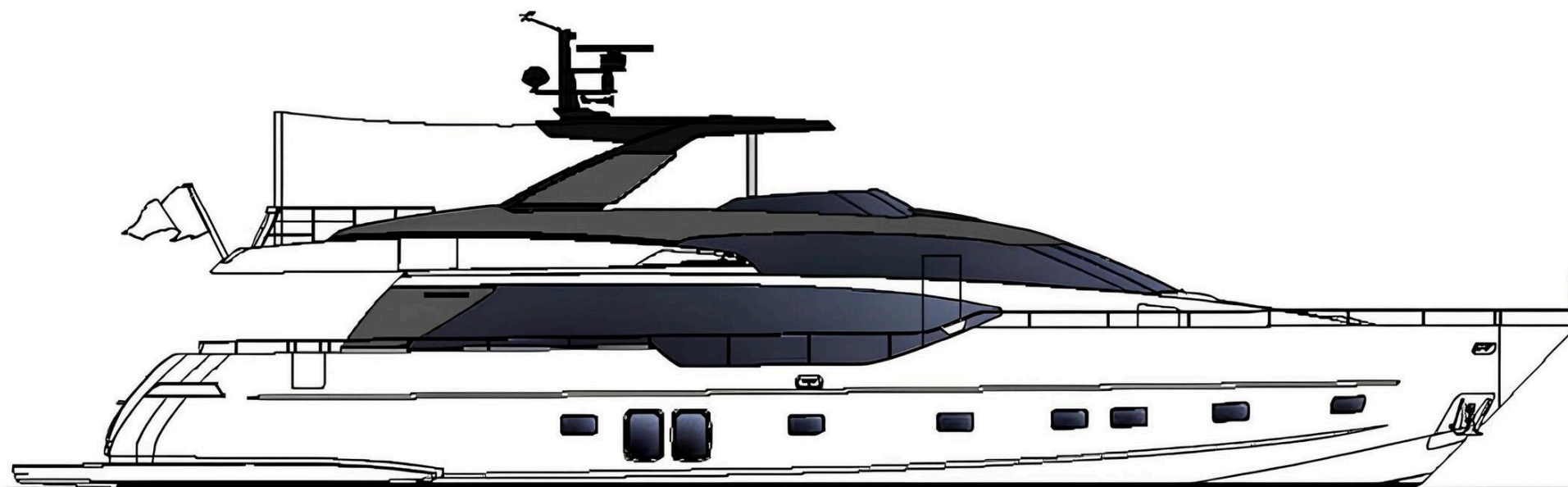

PROFILE

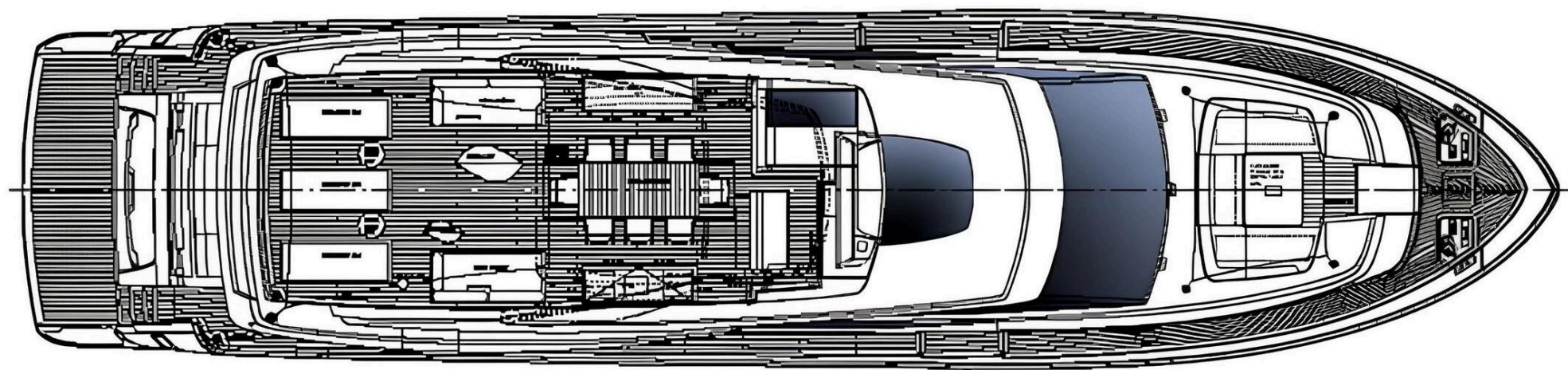

FLYBRIDGE

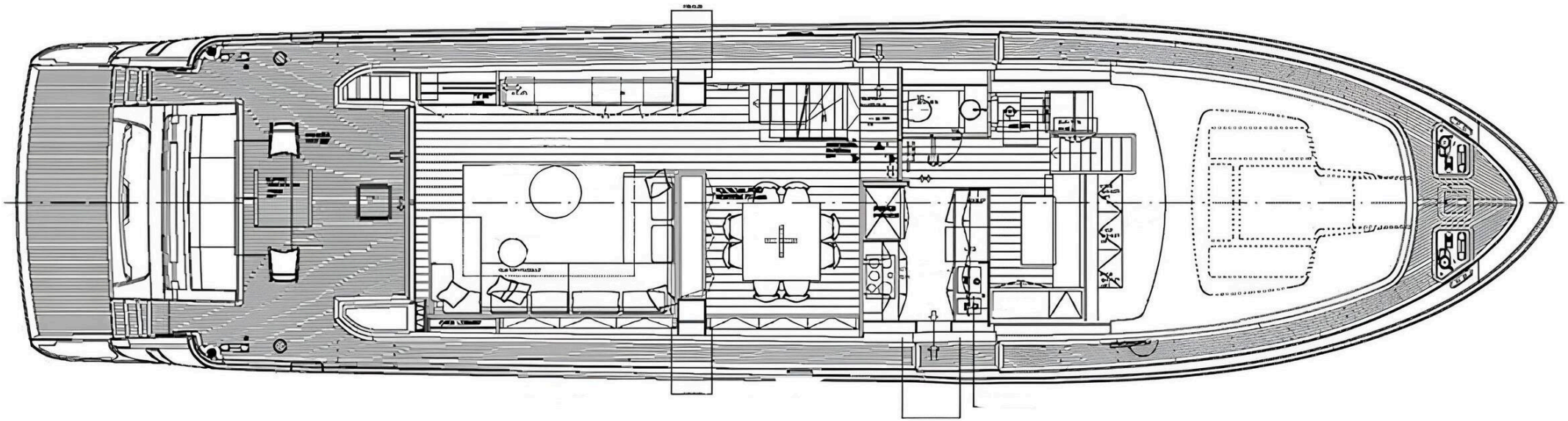

MAIN DECK

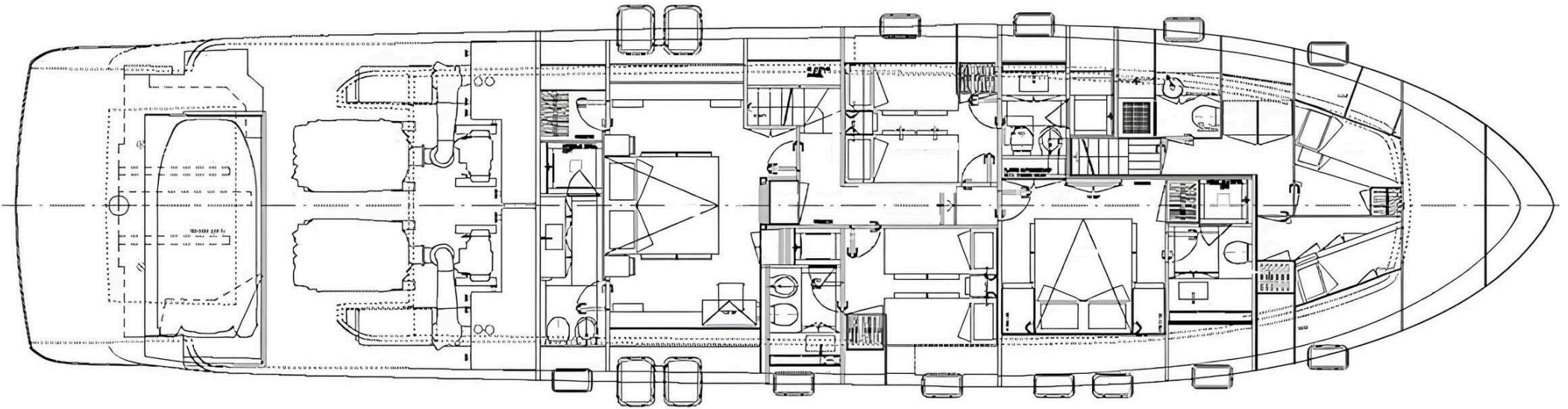

LOWER DECK



KIRILL KUATOV

+377 607 93 15 20

+39 333 576 44 44

[Send e-mail](#)

[WhatsApp](#)

[Telegram](#)