



Brokerage

NAU
YACHTS

BALANCE

MOTOR YACHT SANLORENZO 24.64M 2018

€3,100,000 (VAT paid)
FLAG - АВСТРИЯ

MOTOR YACHT

BALANCE



BALANCE, built in 2021 by **Sanlorenzo**, combines stylish design with exceptional performance. The spacious salon on the main deck is flooded with natural light through panoramic windows, offering breathtaking views of the sea. The dining area for 6 guests and a lounge zone create the perfect setting for relaxation, especially in warm weather.

What sets **BALANCE** apart is its asymmetric layout, which maximizes the salon space, providing ample room for leisure. The master cabin, located on the lower deck, offers privacy with panoramic windows, blackout curtains, LED lighting, and marble floors. The ensuite bathroom features a steam shower. Also located on the lower deck are two additional VIP cabins, each with its own bathroom, along with a guest cabin.

The yacht's flybridge is equipped with an electric hardtop, bar, and lounge area. It also features a large dining table and spacious sunbeds. The electric bimini extends to provide additional shade. **BALANCE** also boasts a spacious beach club with a garage for the tender and water toys. The hydraulic swim platform makes accessing the sea even easier.

Powered by two MAN V12-2000 engines, each delivering 2000 horsepower, **BALANCE** reaches a top speed of 30 knots and a cruising speed of 23 knots. Stabilization ensures a smooth ride both underway and at anchor.

[see more information about M/Y BALANCE at www.nauyachts.com](http://www.nauyachts.com)

SPECIFICATION

SHIPYARD, MODEL	Sanlorenzo SL78
BUILT	2018
LENGTH	24.64 m
WATERLINE LENGTH	21.34 m
HULL CONFIGURATION	PLANING
BEAM	5.74 m
RANGE	320
DRAFT	1.83 m
GROSS TONNAGE	70 GT
YACHT CLASS	RINA
CABINS	4+2
MASTER CABIN	LOWER DECK
GUESTS	8
BERTHS	8+2
CREW	2
HEADS	4+1

EXTERIOR DESIGN	OFFICINA ITALIANA DESIGN
INTERIOR DESIGN	OFFICINA ITALIANA DESIGN
HULL	GRP
SUPERSTRUCTURE	GRP
ENGINES	2 x MTU M96L 10V 2000 1622 h.p.
TYPE OF DRIVE	SHAFT LINE
ENGINE HOURS	1000 h
MAXIMUM SPEED	30 kn
CRUSING SPEED	23 kn
FUEL CONSUMPTION AT ECONOMICAL SPEED	~ 485 l/h
FUEL	5350 l
GREY WATER	N/A
BLACK WATER	N/A
FRESH WATER	1400 l
DISPLACEMENT	N/A

[see more information about M/Y BALANCE at www.nauyachts.com](http://www.nauyachts.com)



EXTERIOR SANLORENZO SL78 2018 MY
BALANCE

M/Y BALANCE



EXTERIOR SANLORENZO SL78 2018 MY
BALANCE

M/Y BALANCE



EXTERIOR SANLORENZO SL78 2018 M/Y
BALANCE

M/Y BALANCE



EXTERIOR SANLORENZO SL78 2018 MY
BALANCE

M/Y BALANCE



EXTERIOR SANLORENZO SL78 2018 MY
BALANCE

M/Y BALANCE



AFT MAIN DECK LOUNGE AREA

M/Y BALANCE



AFT MAIN DECK LOUNGE AREA

M/Y BALANCE



BOW LOUNGE AREA

M/Y BALANCE



BOW LOUNGE AREA

M/Y BALANCE



FLYBRIDGE DINING AREA

M/Y BALANCE



FLYBRIDGE DINING AREA

M/Y BALANCE



FLYBRIDGE AFT SUNBATHING AREA

M/Y BALANCE



SECOND HELM STATION

M/Y BALANCE



MAIN HELM STATION

M/Y BALANCE



MAIN SALON LOUNGE AREA

M/Y BALANCE



MAIN SALON DINING AREA

M/Y BALANCE



STAIRS FROM MD TO LD

M/Y BALANCE



MASTER CABIN

M/Y BALANCE



MASTER CABIN

M/Y BALANCE



MASTER CABIN

M/Y BALANCE



MASTER BATHROOM

M/Y BALANCE



MASTER BATHROOM

M/Y BALANCE



VIP CABIN

M/Y BALANCE



VIP BATHROOM

M/Y BALANCE



VIP CABIN

M/Y BALANCE



VIP BATHROOM

M/Y BALANCE



GUEST CABIN

M/Y BALANCE

General Arrangement



PROFILE

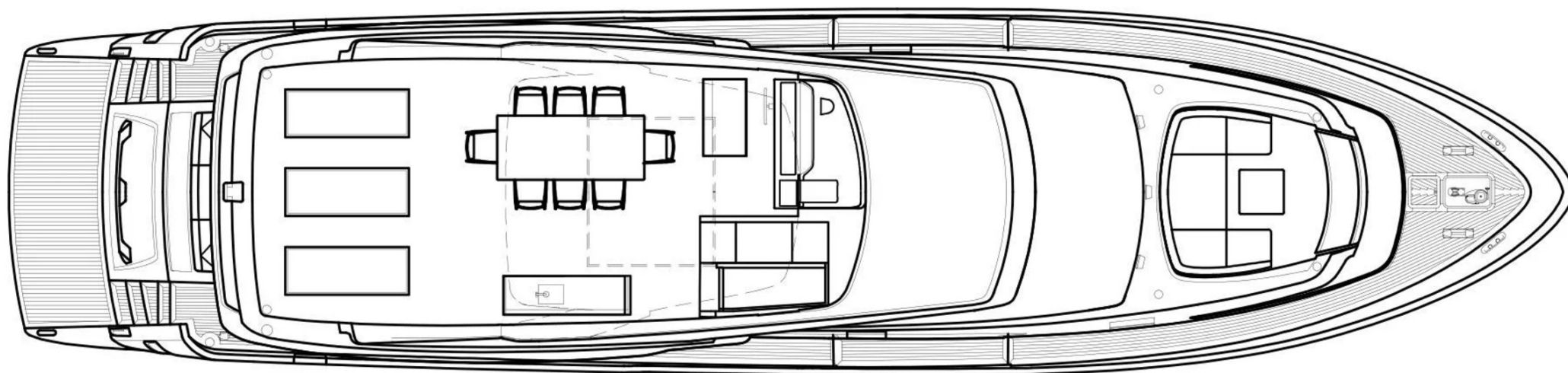

FLYBRIDGE

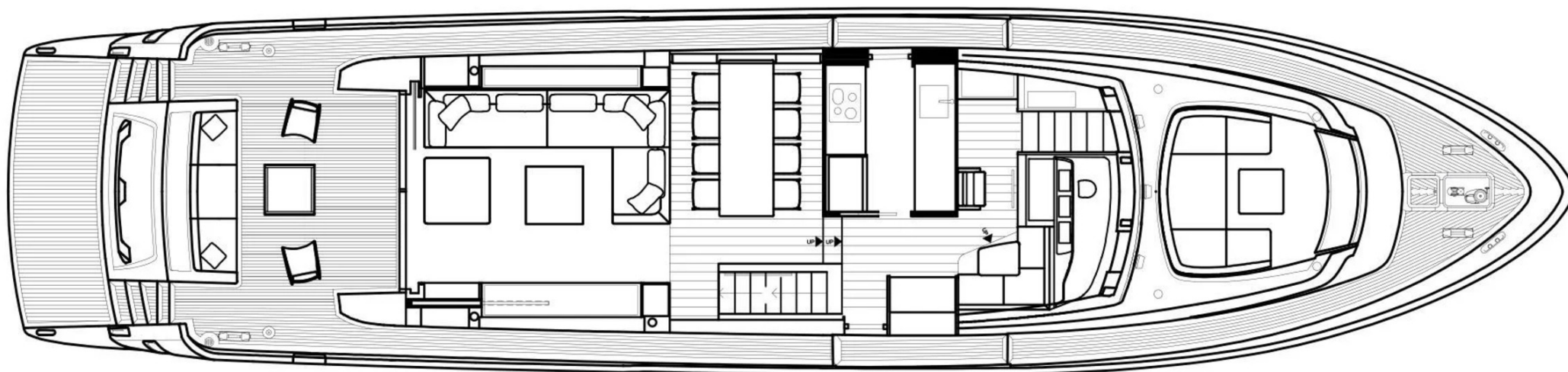

MAIN DECK



LOWER DECK



KIRILL KUATOV

+377 607 93 15 20

+39 333 576 44 44

[Send e-mail](#)

[WhatsApp](#)

[Telegram](#)