



Brokerage

NAU
YACHTS

ALUMINIA TOO

MOTOR YACHT

AZIMUT 26.78M

2024

€6,900,000

FLAG - SLOVAKIA

MOTOR YACHT

ALUMINIA TOO



ALUMINIA TOO, launched in 2024, represents the new generation of the **Azimut Grande 27M** series, combining advanced construction technologies, optimized seakeeping, and a highly functional layout. The interiors by Achille Salvagni reflect **Azimut's** signature approach to spatial design: fluid lines, thoughtful lighting, and the use of premium materials. The layout accommodates up to 10 guests in five cabins, including a full-beam master suite on the main deck, two VIP cabins, and two twin cabins on the lower deck.

The exterior areas of **ALUMINIA TOO** are designed for extended outdoor living. The spacious flybridge is equipped with a hardtop, a dining area, a bar, and multiple lounging spaces. The aft area features a beach club configuration with a fold-down platform, providing direct access to the water. On the foredeck, an additional relaxation area with sunpads and an optional shade system offers yet another comfortable outdoor retreat.

A key advantage of **ALUMINIA TOO** is her upgraded equipment package exceeding €1.2 million, which includes enhanced navigation systems, extended audio and video setups, full teak decking, underwater lighting, advanced docking assistance systems, a watermaker, upgraded domestic appliances, and various convenience-enhancing solutions.

ALUMINIA TOO is a fully loaded, meticulously specified yacht with minimal engine hours and immediate availability, offering an exceptional ownership opportunity in the 27M class.

[see more information about M/Y ALUMINIA TOO at www.nauyachts.com](http://www.nauyachts.com)

SPECIFICATION

SHIPYARD, MODEL	Azimut Grande 27M
BUILT	2024
LENGTH	26.78 m
WATERLINE LENGTH	22.62 m
HULL CONFIGURATION	PLANING
BEAM	6.59 m
RANGE	360
DRAFT	1.93 m
GROSS TONNAGE	145 GT
YACHT CLASS	RINA
CABINS	5+2
MASTER CABIN	MAIN DECK
GUESTS	10
BERTHS	10+4
CREW	4
HEADS	6+1

EXTERIOR DESIGN	STEFANO RIGHINI DESIGN
INTERIOR DESIGN	ACHILLE SALVAGNI ARCHITETTI
HULL	GRP
SUPERSTRUCTURE	GRP
ENGINES	2 x MAN R V12 1900 h.p.
TYPE OF DRIVE	SHAFT LINE
ENGINE HOURS	565 h
MAXIMUM SPEED	28 kn
CRUISING SPEED	24 kn
FUEL CONSUMPTION AT ECONOMICAL SPEED	~ 394 l/h
FUEL	9500 l
GREY WATER	850 l
BLACK WATER	850 l
FRESH WATER	2000 l
DISPLACEMENT	92.96

[see more information about M/Y ALUMINIA TOO at www.nauyachts.com](http://www.nauyachts.com)



EXTERIOR AZIMUT GRANDE 27M 2024 MY
ALUMINIA TOO

M/Y ALUMINIA TOO



EXTERIOR AZIMUT GRANDE 27M 2024 MY
ALUMINIA TOO

M/Y ALUMINIA TOO



EXTERIOR AZIMUT GRANDE 27M 2024 MY
ALUMINIA TOO

M/Y ALUMINIA TOO



EXTERIOR AZIMUT GRANDE 27M 2024 MY
ALUMINIA TOO

M/Y ALUMINIA TOO



EXTERIOR AZIMUT GRANDE 27M 2024 MY
ALUMINIA TOO

M/Y ALUMINIA TOO



EXTERIOR AZIMUT GRANDE 27M 2024 MY
ALUMINIA TOO

M/Y ALUMINIA TOO



EXTERIOR AZIMUT GRANDE 27M 2024 MY
ALUMINIA TOO

M/Y ALUMINIA TOO



COCKPIT SEATING AREA

M/Y ALUMINIA TOO



BOW LOUNGE AREA

M/Y ALUMINIA TOO



BOW LOUNGE AREA

M/Y ALUMINIA TOO



BOW LOUNGE AREA

M/Y ALUMINIA TOO



FLYBRIDGE LOUNGE AREA

M/Y ALUMINIA TOO



FLYBRIDGE LOUNGE AREA

M/Y ALUMINIA TOO



FLYBRIDGE LOUNGE AREA

M/Y ALUMINIA TOO



FLYBRIDGE LOUNGE AREA

M/Y ALUMINIA TOO



WATER TOYS

M/Y ALUMINIA TOO



WATER TOYS

M/Y ALUMINIA TOO



WATER TOYS

M/Y ALUMINIA TOO



WATER TOYS

M/Y ALUMINIA TOO



WATER TOYS

M/Y ALUMINIA TOO



MAIN SALON LOUNGE AREA

M/Y ALUMINIA TOO



MAIN SALON LOUNGE AREA

M/Y ALUMINIA TOO



MAIN SALON LOUNGE AREA

M/Y ALUMINIA TOO



MAIN SALON LOUNGE AREA

M/Y ALUMINIA TOO



MASTER CABIN

M/Y ALUMINIA TOO



MASTER CABIN

M/Y ALUMINIA TOO



MASTER CABIN

M/Y ALUMINIA TOO



MAKE-UP TABLE IN MASTER CABIN

M/Y ALUMINIA TOO



MASTER CABIN

M/Y ALUMINIA TOO



MASTER BATHROOM

M/Y ALUMINIA TOO



VIP CABIN

M/Y ALUMINIA TOO



VIP CABIN

M/Y ALUMINIA TOO



VIP BATHROOM

M/Y ALUMINIA TOO



GUEST CABIN

M/Y ALUMINIA TOO



GUEST CABIN

M/Y ALUMINIA TOO

General Arrangement

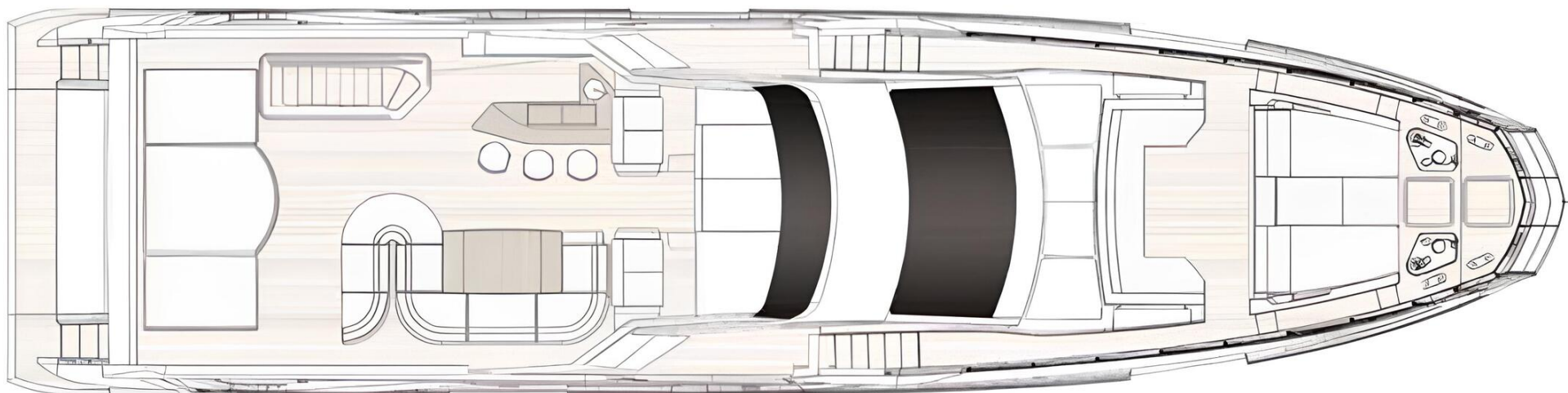

FLYBRIDGE

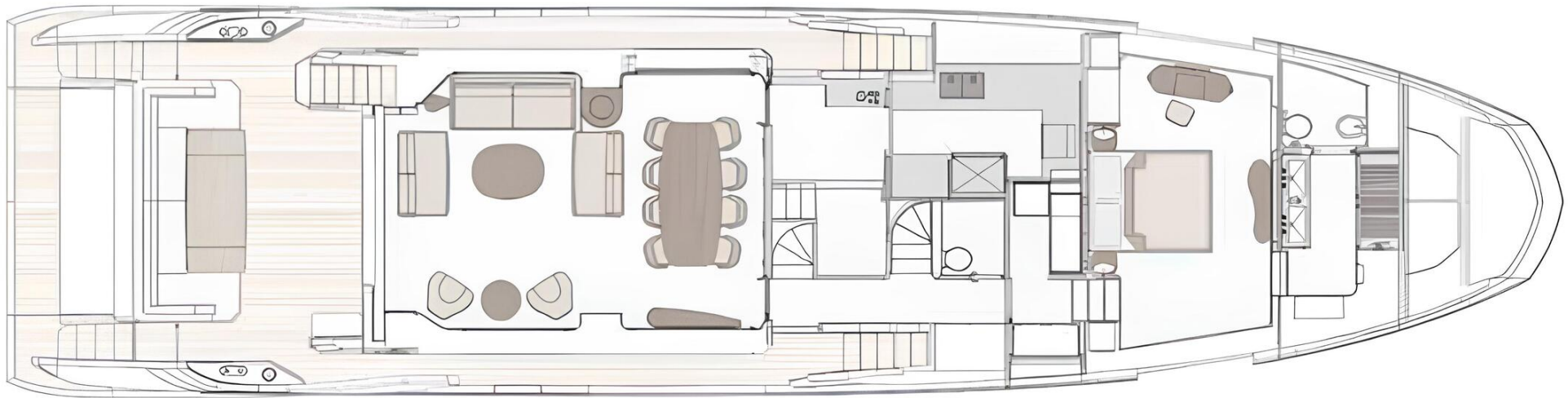

MAIN DECK

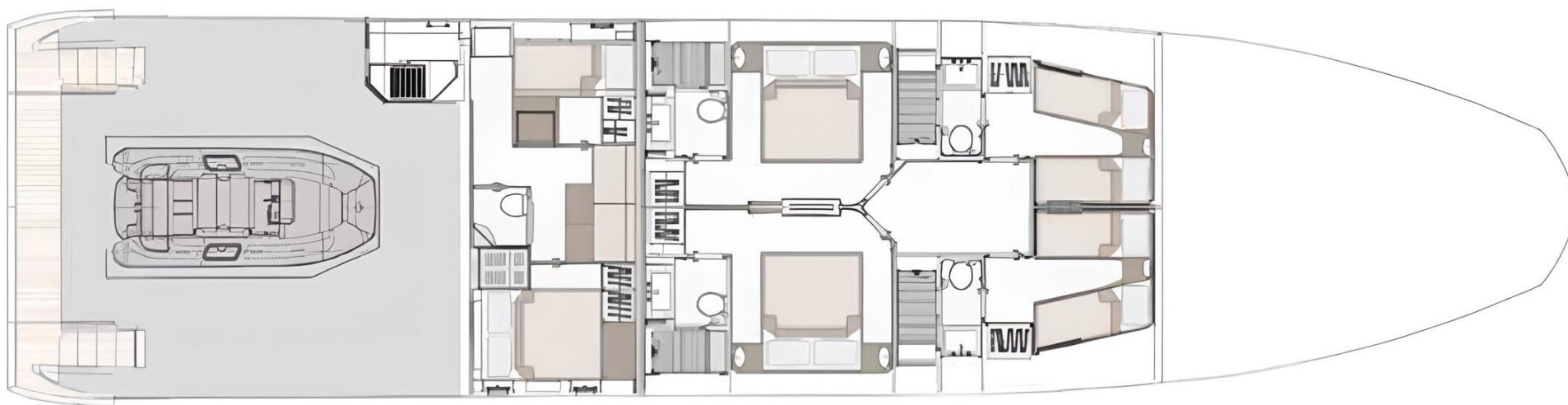

LOWER DECK



KIRILL KUATOV

+377 607 93 15 20

+39 333 576 44 44

 [Send e-mail](#)

 WhatsApp

 Telegram

[More information about M/Y ALUMINIA TOO at www.nauyachts.com](#)

[Watch video](#)