



Brokerage

NAU
YACHTS

SEVEN SINS

MOTOR YACHT SANLORENZO 52M 2017

€28,000,000
FLAG - CAYMAN ISLANDS

MOTOR YACHT

SEVEN SINS

SEVEN SINS is a 52-metre superyacht, built in 2017 by **Sanlorenzo**, designed to accommodate 11 guests in five cabins, including a master cabin on the main deck. The yacht is operated by a crew of 11, ensuring high-level service and smooth operation. Interiors were created by Officina Italiana Design in a modern style with a neutral palette, combining white, beige, warm leather, and accents of marble and glass.

Outdoor areas feature multiple dining and lounge zones, a pool with a glass bottom, and a beach club. The sundeck and foredeck provide ample space for sunbathing. For water activities, the yacht is equipped with a full range of water toys, including jet skis, Seabobs, a foilboard, wakeboards, water skis, kayaks, SUP boards, a pool, water slide, and snorkeling and fishing equipment.

Powered by two Caterpillar 3512C engines, **SEVEN SINS** reaches a cruising speed of 13.5 knots, a maximum speed of 17 knots, and offers a range of 4,000 nautical miles at economical speed.

[see more information about M/Y SEVEN SINS at www.nauyachts.com](http://www.nauyachts.com)

SPECIFICATION

SHIPYARD, MODEL	Sanlorenzo 52Steel
BUILT	2017
LENGTH	52 m
WATERLINE LENGTH	46.2 m
HULL CONFIGURATION	DISPLACEMENT
BEAM	9.35 m
RANGE	3000
DRAFT	2.7 m
GROSS TONNAGE	499 GT
YACHT CLASS	RINA
CABINS	5+3
MASTER CABIN	MAIN DECK
GUESTS	11
BERTHS	11+6
CREW	6
HEADS	7+3

EXTERIOR DESIGN	OFFICINA ITALIANA DESIGN
INTERIOR DESIGN	SANLORENZO
HULL	STEEL
SUPERSTRUCTURE	ALUMINIUM
ENGINES	2 x Caterpillar 3512C DITA-SCAC 2040 h.p.
TYPE OF DRIVE	SHAFT LINE
ENGINE HOURS	13923 h
MAXIMUM SPEED	17 kn
CRUISING SPEED	13.5 kn
FUEL CONSUMPTION AT ECONOMICAL SPEED	~ 280 l/h
FUEL	66000 l
GREY WATER	1900 l
BLACK WATER	1900 l
FRESH WATER	15000 l
DISPLACEMENT	480

[see more information about M/Y SEVEN SINS at www.nauyachts.com](http://www.nauyachts.com)



EXTERIOR SANLORENZO 52STEEL 2017 MY
SEVEN SINS

M/Y SEVEN SINS



EXTERIOR SANLORENZO 52STEEL 2017 MY
SEVEN SINS

M/Y SEVEN SINS



EXTERIOR SANLORENZO 52STEEL 2017 MY
SEVEN SINS

M/Y SEVEN SINS



EXTERIOR SANLORENZO 52STEEL 2017 MY
SEVEN SINS

M/Y SEVEN SINS



EXTERIOR SANLORENZO 52STEEL 2017 MY
SEVEN SINS

M/Y SEVEN SINS



EXTERIOR SANLORENZO 52STEEL 2017 MY
SEVEN SINS

M/Y SEVEN SINS



EXTERIOR

M/Y SEVEN SINS



EXTERIOR

M/Y SEVEN SINS



EXTERIOR

M/Y SEVEN SINS



EXTERIOR

M/Y SEVEN SINS



EXTERIOR

M/Y SEVEN SINS



EXTERIOR

M/Y SEVEN SINS



MAIN SALON LOUNGE AREA

M/Y SEVEN SINS



MAIN SALON LOUNGE AREA

M/Y SEVEN SINS



MAIN SALON LOBBY

M/Y SEVEN SINS



MAIN SALON DINING AREA

M/Y SEVEN SINS



MASTER CABIN

M/Y SEVEN SINS



OFFICE IN THE MASTER CABIN

M/Y SEVEN SINS



MASTER BATHROOM

M/Y SEVEN SINS



VIP CABIN

M/Y SEVEN SINS



VIP CABIN

M/Y SEVEN SINS



VIP BATHROOM

M/Y SEVEN SINS



GUEST CABIN

M/Y SEVEN SINS



GUEST BATHROOM

M/Y SEVEN SINS



BEACH CLUB

M/Y SEVEN SINS



SAUNA

M/Y SEVEN SINS



MAIN HELM STATION

M/Y SEVEN SINS

General Arrangement

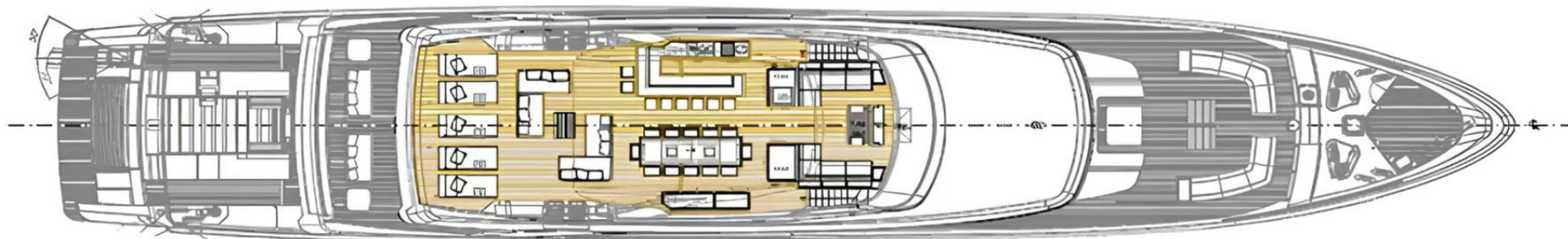

SUNDECK

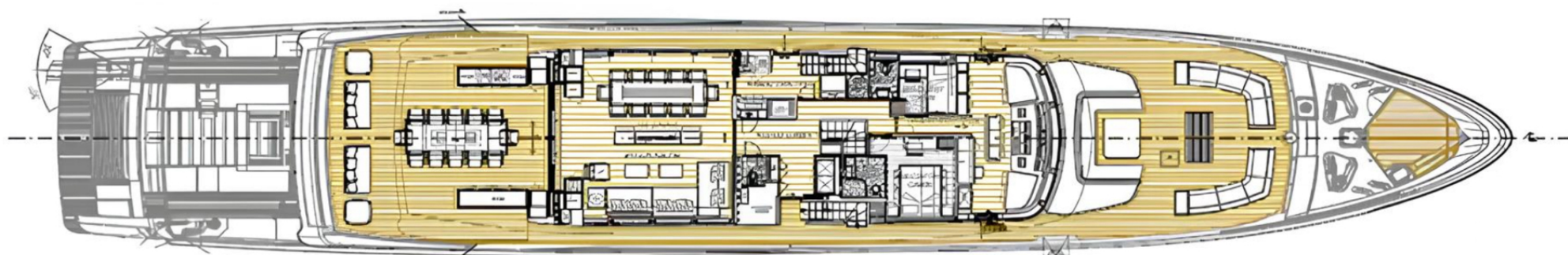

UPPER DECK



MAIN DECK

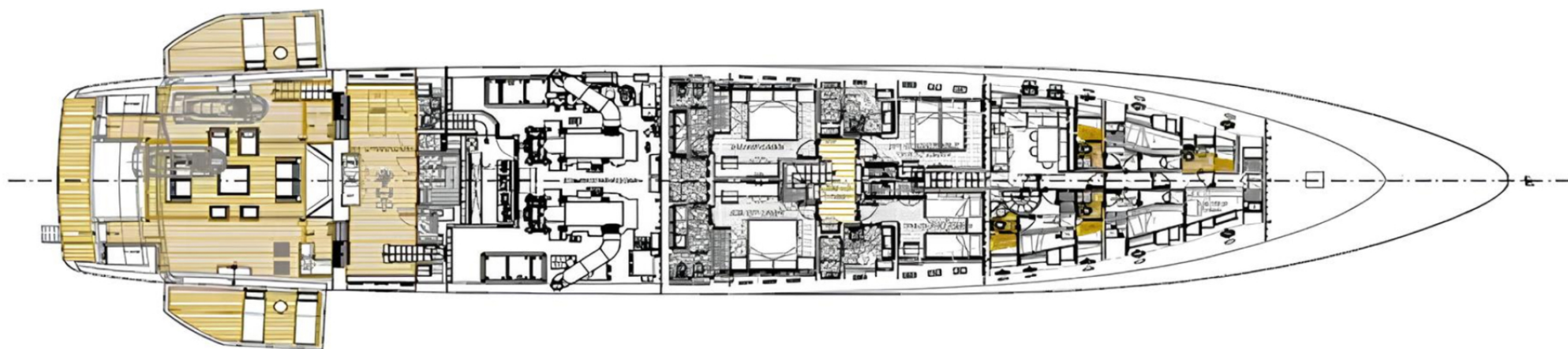

LOWER DECK



KIRILL KUATOV

+377 607 93 15 20

+39 333 576 44 44

 [Send e-mail](#)

 WhatsApp

 Telegram