



Brokerage

NAU
YACHTS

ORION

MOTOR YACHT VAN DER VALK 24.6M 2014

(VAT paid)
FLAG - MALTA

MOTOR YACHT

ORION

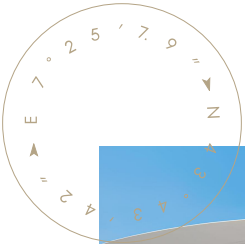

ORION is a 26-meter semi-custom motor yacht from the **Continental II** series, built in the Netherlands by **Van der Valk** in 2014. Featuring an enlarged beam and a flybridge with a hardtop, this all-aluminium yacht was constructed to CE Category A standards, ensuring strength, stability, and excellent seakeeping performance. In 2023, **ORION** underwent a comprehensive refit, which included full technical servicing and a complete interior refurbishment. The yacht's classic Victorian-inspired décor was refreshed with contemporary finishes, new soft furnishings, and lighting, creating an elegant and inviting atmosphere.

Accommodation is provided for up to 8 guests in 4 cabins, including a full-beam master suite and a spacious VIP cabin. The main salon combines a comfortable lounge with a dining area, while the outdoor decks offer multiple leisure options — an aft cockpit with dining space, a flybridge with bar and sun loungers, and a forward sunbathing area.

Powered by three Volvo Penta D13-800 diesel engines, **ORION** reaches a cruising speed of 21.5 knots and a top speed of 26.7 knots. Technical highlights include a Seakeeper M21000 gyro stabilizer, hydraulic swim platform, watermaker, Simrad navigation system, and Delta DB sound insulation.

After her 2023 refit, **ORION** is presented in excellent technical and aesthetic condition, fully equipped and ready for immediate cruising.

[see more information about M/Y ORION at www.nauyachts.com](http://www.nauyachts.com)

SPECIFICATION

SHIPYARD, MODEL	Van Der Valk Continental II
BUILT	2014
LENGTH	24.6 m
WATERLINE LENGTH	18.7 m
HULL CONFIGURATION	PLANING
BEAM	6.25 m
RANGE	1500
DRAFT	1.35 m
GROSS TONNAGE	N/A
YACHT CLASS	CE (A)
CABINS	4+1
MASTER CABIN	LOWER DECK
GUESTS	8
BERTHS	8+2
CREW	2
HEADS	4+1

EXTERIOR DESIGN	WIM VAN DER VALK CONTINENTAL YACHTS
INTERIOR DESIGN	WIM VAN DER VALK CONTINENTAL YACHTS
HULL	ALUMINUM
SUPERSTRUCTURE	ALUMINIUM
ENGINES	3 x Volvo Penta D13 800 h.p.
TYPE OF DRIVE	VOLVO PENTA IPS
ENGINE HOURS	929 h
MAXIMUM SPEED	26.7 kn
CRUISING SPEED	21.5 kn
FUEL CONSUMPTION AT ECONOMICAL SPEED	N/A
FUEL	12500 l
GREY WATER	800 l
BLACK WATER	800 l
FRESH WATER	1600 l
DISPLACEMENT	65

[see more information about M/Y ORION at www.nauyachts.com](http://www.nauyachts.com)



EXTERIOR VAN DER VALK CONTINENTAL II
2014 MY ORION

M/Y ORION



EXTERIOR VAN DER VALK CONTINENTAL II
2014 MY ORION

M/Y ORION



EXTERIOR VAN DER VALK CONTINENTAL II
2014 MY ORION

M/Y ORION



EXTERIOR VAN DER VALK CONTINENTAL II
2014 MY ORION

M/Y ORION



EXTERIOR VAN DER VALK CONTINENTAL II
2014 MY ORION

M/Y ORION



EXTERIOR VAN DER VALK CONTINENTAL II
2014 MY ORION

M/Y ORION



BOW AREA

M/Y ORION



FLYBRIDGE LOUNGE AREA

M/Y ORION



AFT AREA

M/Y ORION



AFT AREA

M/Y ORION



COCKPIT DINING AREA

M/Y ORION



COCKPIT DINING AREA

M/Y ORION



STARBOARD

M/Y ORION



BOW LOUNGE AREA

M/Y ORION



STAIRS FROM MD TO FLYBRIDGE

M/Y ORION



FLYBRIDGE LOUNGE AREA

M/Y ORION



FLYBRIDGE LOUNGE AREA

M/Y ORION



FLYBRIDGE LOUNGE AREA

M/Y ORION



SECOND HELM STATION

M/Y ORION



FLYBRIDGE AFT SUNBATHING AREA

M/Y ORION



MAIN SALON LOUNGE AREA

M/Y ORION



MAIN SALON LOUNGE AREA

M/Y ORION



MAIN SALON BAR

M/Y ORION



MAIN SALON DINING AREA

M/Y ORION



GALLEY

M/Y ORION



GALLEY

M/Y ORION



MAIN HELM STATION

M/Y ORION



MASTER CABIN

M/Y ORION



MASTER CABIN LOUNGE AREA

M/Y ORION



MASTER BATHROOM

M/Y ORION



VIP CABIN

M/Y ORION



VIP BATHROOM

M/Y ORION



VIP CABIN

M/Y ORION



VIP BATHROOM

M/Y ORION



LOWER DECK LOBBY

M/Y ORION

General Arrangement

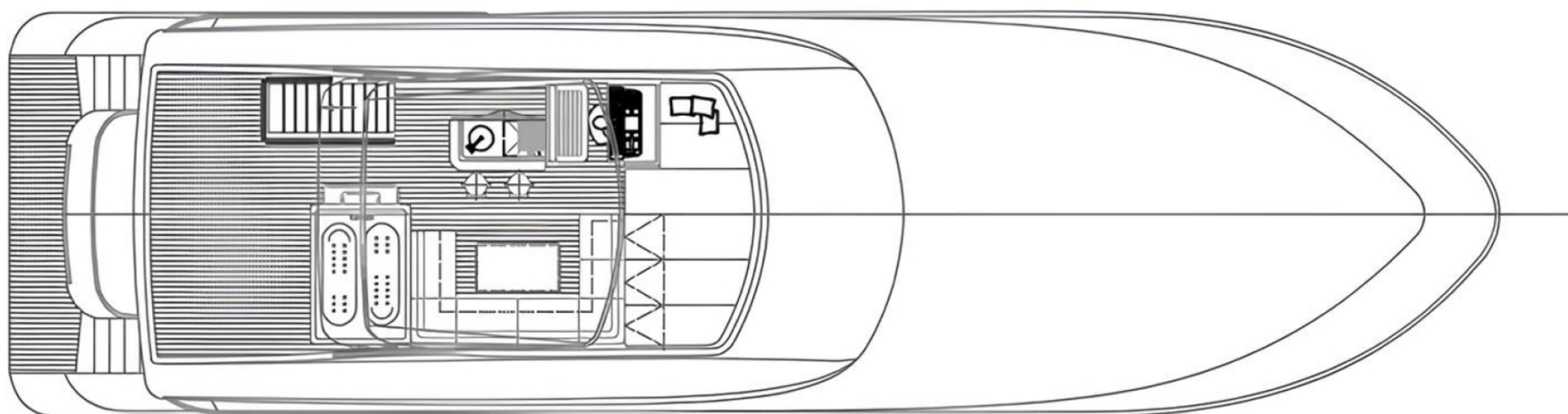

FLYBRIDGE

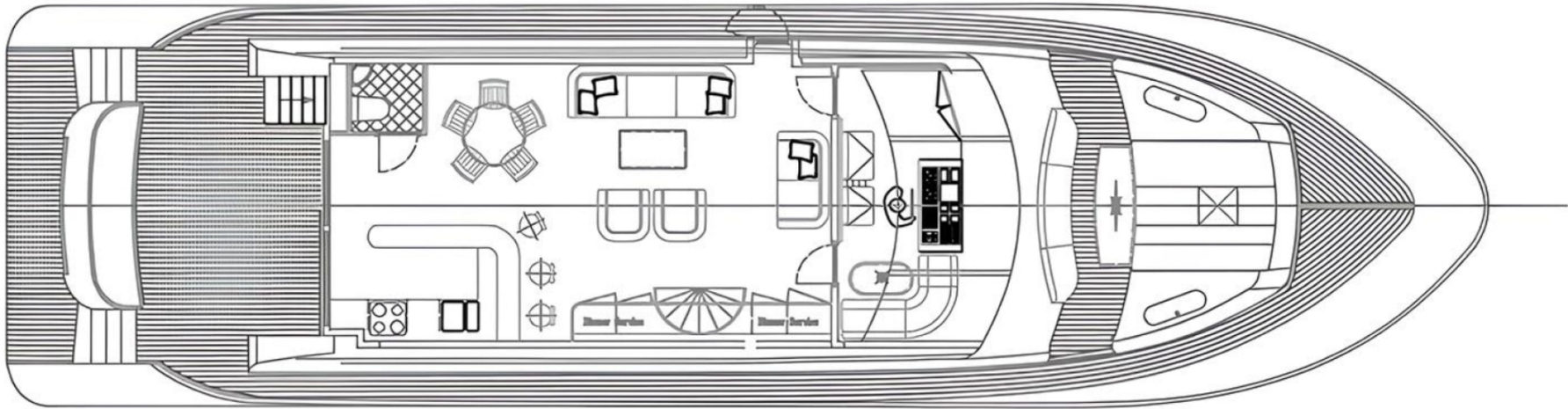

MAIN DECK

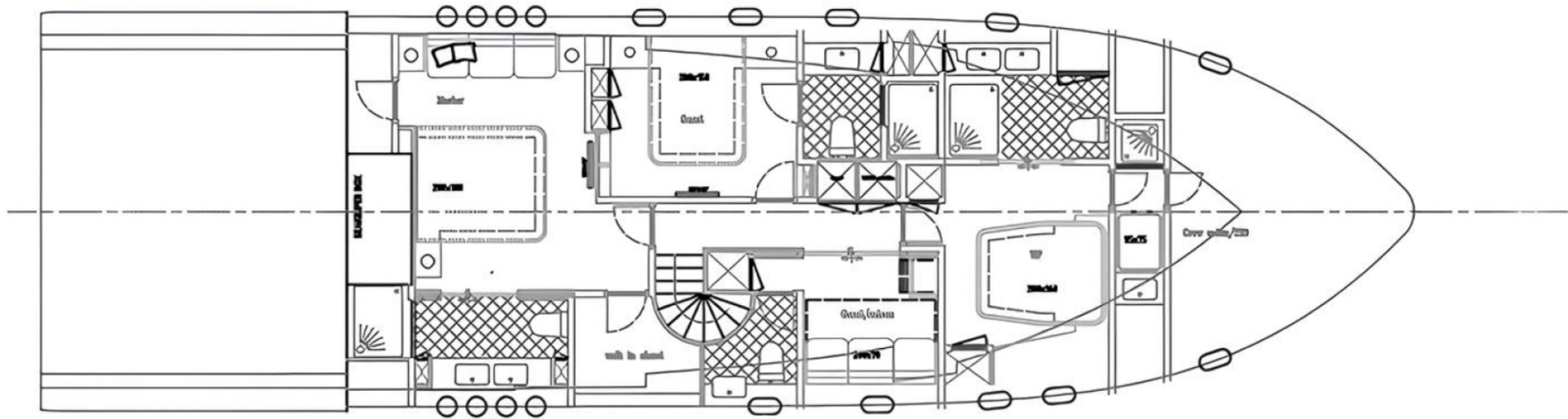

LOWER DECK



KIRILL KUATOV

+377 607 93 15 20

+39 333 576 44 44

 [Send e-mail](#)

 WhatsApp

 Telegram

[More information about M/Y ORION at www.nauyachts.com](#)

[Watch video](#)