



Brokerage

NAU
YACHTS

LADY ALINA

MOTOR YACHT SANLORENZO 27.6M 2011

€3,995,000

FLAG - UK

MOTOR YACHT

LADY ALINA



LADY ALINA is a **Sanlorenzo SD92** motor yacht built in 2011 and comprehensively refitted in 2024. She blends the timeless semi-displacement SD hull architecture with spacious living areas designed for extended stays on the water.

A standout feature for a yacht of her size, the full-beam master suite is located on the main deck and benefits from panoramic windows, a private bathroom and a walk-in wardrobe. On the lower deck, accommodation comprises two VIP cabins and two guest cabins with twin beds. Separate crew quarters for four ensure discreet service and guest privacy.

Her exterior spaces offer a variety of relaxation areas including a large swim platform for easy access to the sea, a shaded dining area in the cockpit, sunpads on the foredeck and a comfortable flybridge lounge.

Powered by twin MAN V12 diesel engines of 1,200 hp each, **LADY ALINA** cruises at 15 knots and reaches a top speed of 18 knots, with a range of up to 1,500 nautical miles. Following her recent refit, she is in excellent technical condition and turnkey-ready for her next owner.

[see more information about M/Y LADY ALINA at www.nauyachts.com](http://www.nauyachts.com)

SPECIFICATION

SHIPYARD, MODEL	Sanlorenzo SD92
BUILT	2011
LENGTH	27.6 m
WATERLINE LENGTH	24.9 m
HULL CONFIGURATION	SEMI-DISPLACEMENT
BEAM	7.15 m
RANGE	1500
DRAFT	1.8 m
GROSS TONNAGE	193 GT
YACHT CLASS	RINA
CABINS	5+3
MASTER CABIN	MAIN DECK
GUESTS	10
BERTHS	10+4
CREW	4
HEADS	5+3

EXTERIOR DESIGN	FRANCESCO PASZKOWSKI
INTERIOR DESIGN	FRANCESCO PASZKOWSKI
HULL	GRP
SUPERSTRUCTURE	GRP
ENGINES	2 x MAN V12 1200 h.p.
TYPE OF DRIVE	SHAFT LINE
ENGINE HOURS	4135 h
MAXIMUM SPEED	18 kn
CRUISING SPEED	15 kn
FUEL CONSUMPTION AT ECONOMICAL SPEED	~ 110 l/h
FUEL	16000 l
GREY WATER	1000 l
BLACK WATER	1000 l
FRESH WATER	2500 l
DISPLACEMENT	108

[see more information about M/Y LADY ALINA at www.nauyachts.com](http://www.nauyachts.com)



EXTERIOR SANLORENZO SD92 2011 MY LADY
ALINA

M/Y LADY ALINA



EXTERIOR SANLORENZO SD92 2011 MY LADY
ALINA

M/Y LADY ALINA



EXTERIOR SANLORENZO SD92 2011 MY LADY
ALINA

M/Y LADY ALINA



EXTERIOR SANLORENZO SD92 2011 MY LADY
ALINA

M/Y LADY ALINA



EXTERIOR SANLORENZO SD92 2011 MY LADY
ALINA

M/Y LADY ALINA



EXTERIOR SANLORENZO SD92 2011 MY LADY
ALINA

M/Y LADY ALINA



EXTERIOR SANLORENZO SD92 2011 MY LADY
ALINA

M/Y LADY ALINA



EXTERIOR SANLORENZO SD92 2011 MY LADY
ALINA

M/Y LADY ALINA



BOW AREA

M/Y LADY ALINA



FLYBRIDGE LOUNGE AREA

M/Y LADY ALINA



FLYBRIDGE LOUNGE AREA

M/Y LADY ALINA



FLYBRIDGE GRILL

M/Y LADY ALINA



FLYBRIDGE LOUNGE AREA

M/Y LADY ALINA



AFT AREA

M/Y LADY ALINA



COCKPIT SEATING AREA

M/Y LADY ALINA



COCKPIT SEATING AREA

M/Y LADY ALINA



COCKPIT SEATING AREA

M/Y LADY ALINA



MAIN SALON LOUNGE AREA

M/Y LADY ALINA



MAIN SALON LOUNGE AREA

M/Y LADY ALINA



MAIN SALON LOUNGE AREA

M/Y LADY ALINA



MAIN SALON DINING AREA

M/Y LADY ALINA



MASTER CABIN

M/Y LADY ALINA



MASTER CABIN

M/Y LADY ALINA



MASTER CABIN

M/Y LADY ALINA



MASTER CABIN

M/Y LADY ALINA



MASTER CABIN DRESSING ROOM

M/Y LADY ALINA



MASTER BATHROOM

M/Y LADY ALINA



VIP CABIN

M/Y LADY ALINA



VIP CABIN

M/Y LADY ALINA



VIP CABIN

M/Y LADY ALINA



GUEST CABIN

M/Y LADY ALINA



GUEST CABIN

M/Y LADY ALINA



GUEST CABIN

M/Y LADY ALINA

General Arrangement

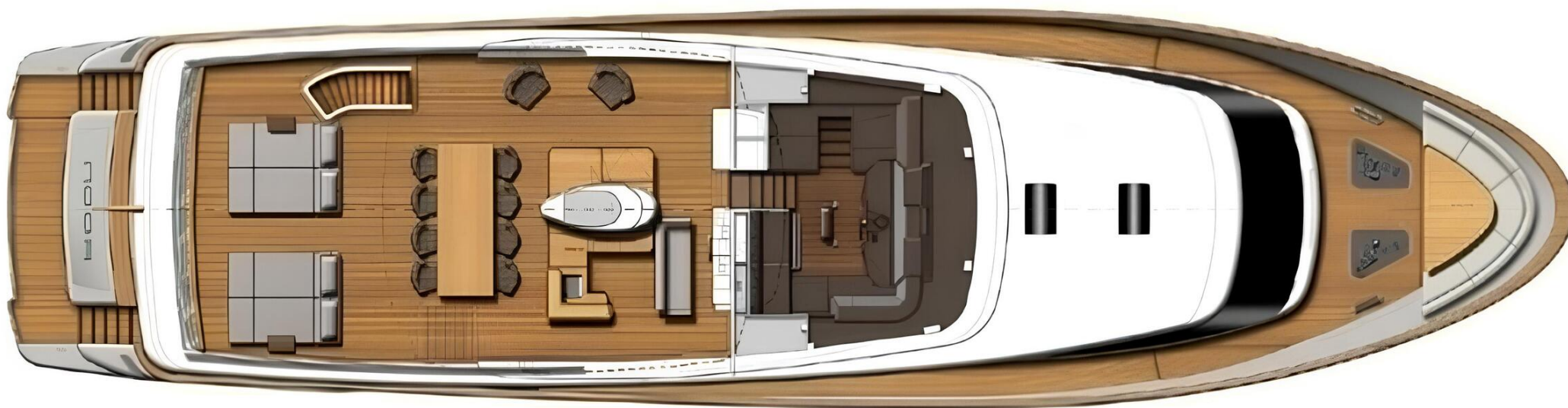

FLYBRIDGE

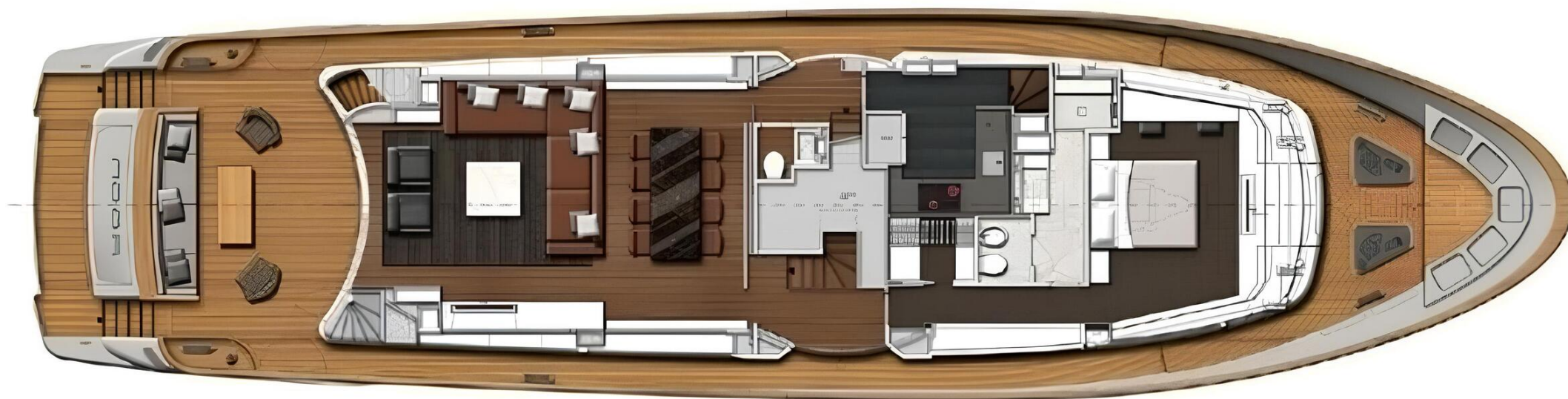

MAIN DECK



LOWER DECK



KIRILL KUATOV

+377 607 93 15 20

+39 333 576 44 44

 [Send e-mail](#)

 WhatsApp

 Telegram