



Brokerage

NAU
YACHTS

SEXY ME

MOTOR YACHT CUSTOM BUILT 27.75M 2024

€8,800,000

FLAG - CAYMAN ISLANDS

MOTOR YACHT

SEXY ME



SEXY ME is the flagship of **Otam's** new **90 GTS** series, launched in 2024. This 27.75-metre high-performance motor yacht perfectly combines exhilarating speed with bespoke Italian design. Built to the exacting specifications of an experienced owner, she embodies **Otam's** philosophy of fully custom yachts and is ready for immediate delivery.

Her sleek Aramat-Kevlar hull features a metallic silver finish with bronze accents, protected by a transparent film, highlighting both modern elegance and power. Exterior styling is by BG Design Firm, with naval architecture by Umberto Tagliavini and Aldo Scorzoni. Twin MTU 16V 2000 M96L engines deliver speeds in excess of 42 knots, with a comfortable cruising speed of around 36 knots. Thoughtful insulation ensures quiet, smooth passage, while a Seakeeper 26 stabilizer provides comfort at anchor.

Inside, **SEXY ME** showcases the artistry of Italian craftsmanship: marble, travertine, and custom parquet floors create an interior that is both contemporary and timeless. Accommodation is for guests in three cabins, including a full-beam lower-deck owner's suite, a spacious VIP cabin, and a twin cabin, with two dedicated crew cabins.

Exterior spaces are designed for relaxation and entertainment. The cockpit features a generous sunbathing area with direct access to the swim platform, while the foredeck lounge is perfect for al fresco dining or sunset cocktails.

SEXY ME combines bold styling, high-speed performance, and meticulously crafted interiors, making her ideal for private ownership or as a support and chase yacht.

[see more information about M/Y SEXY ME at www.nauyachts.com](http://www.nauyachts.com)

SPECIFICATION

SHIPYARD, MODEL	Custom Built 90 GTS
BUILT	2024
LENGTH	27.75 m
WATERLINE LENGTH	23.53 m
HULL CONFIGURATION	PLANING
BEAM	6 m
RANGE	350
DRAFT	1.52 m
GROSS TONNAGE	75 GT
YACHT CLASS	RINA
CABINS	3+2
MASTER CABIN	LOWER DECK
GUESTS	6
BERTHS	6+4
CREW	4
HEADS	3+1

EXTERIOR DESIGN	GIUSEPPE BAGNARDI, BG DESIGN
INTERIOR DESIGN	BG DESIGN
HULL	GRP
SUPERSTRUCTURE	GRP
ENGINES	2 x MTU 16V 2000 M96L 2600 h.p.
TYPE OF DRIVE	SHAFT LINE
ENGINE HOURS	N/A
MAXIMUM SPEED	42 kn
CRUSING SPEED	36 kn
FUEL CONSUMPTION AT ECONOMICAL SPEED	N/A
FUEL	8000 l
GREY WATER	N/A
BLACK WATER	N/A
FRESH WATER	1200 l
DISPLACEMENT	N/A

[see more information about M/Y SEXY ME at www.nauyachts.com](http://www.nauyachts.com)



EXTERIOR OTAM 90 GTS 2024 MY SEXY ME

M/Y SEXY ME



EXTERIOR OTAM 90 GTS 2024 MY SEXY ME

M/Y SEXY ME



EXTERIOR OTAM 90 GTS 2024 MY SEXY ME

M/Y SEXY ME



EXTERIOR OTAM 90 GTS 2024 MY SEXY ME

M/Y SEXY ME



AFT AREA

M/Y SEXY ME



AFT AREA

M/Y SEXY ME



COCKPIT SEATING AREA

M/Y SEXY ME



COCKPIT SEATING AREA

M/Y SEXY ME



COCKPIT SEATING AREA

M/Y SEXY ME



COCKPIT SEATING AREA

M/Y SEXY ME



BOW LOUNGE AREA

M/Y SEXY ME



BOW LOUNGE AREA

M/Y SEXY ME



MAIN SALON LOUNGE AREA

M/Y SEXY ME



MAIN HELM STATION

M/Y SEXY ME



MAIN SALON BAR

M/Y SEXY ME



VIP CABIN

M/Y SEXY ME



VIP CABIN

M/Y SEXY ME



VIP CABIN

M/Y SEXY ME



VIP BATHROOM

M/Y SEXY ME



MASTER CABIN

M/Y SEXY ME



MASTER CABIN

M/Y SEXY ME



MASTER CABIN

M/Y SEXY ME



MASTER BATHROOM

M/Y SEXY ME



GUEST CABIN

M/Y SEXY ME



GUEST BATHROOM

M/Y SEXY ME



GALLEY

M/Y SEXY ME



GALLEY

M/Y SEXY ME

General Arrangement

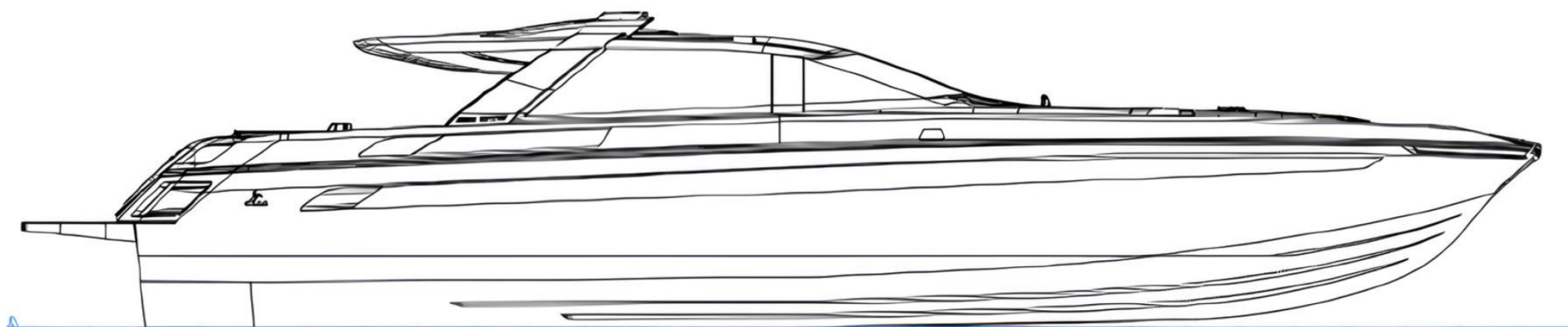

PROFILE

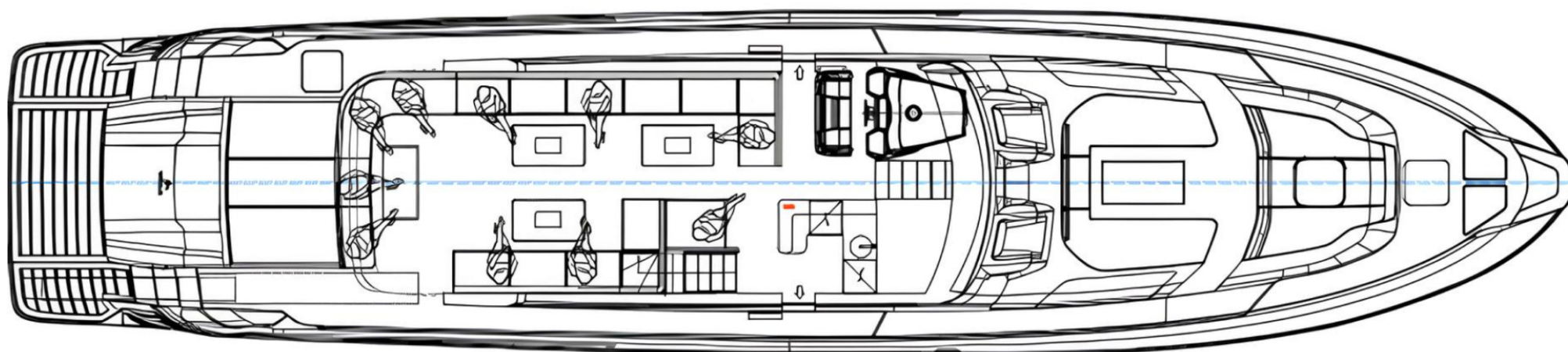

MAIN DECK

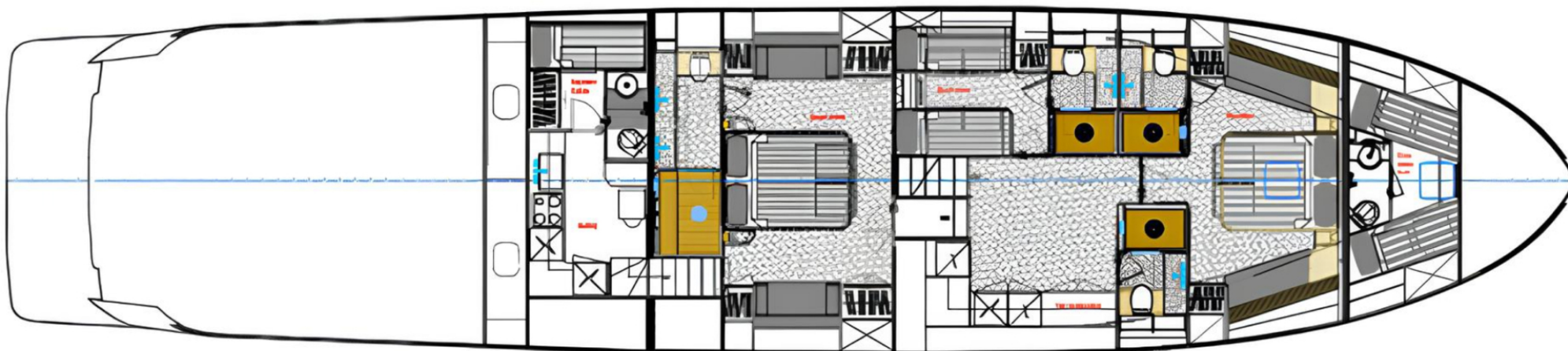

LOWER DECK



KIRILL KUATOV

+377 607 93 15 20

+39 333 576 44 44

 [Send e-mail](#)

 WhatsApp

 Telegram

[More information about M/Y SEXY ME at www.nauyachts.com](#)

[Watch video](#)