



New Build

NAU
YACHTS

PROJECT FUN

MOTOR YACHT LEADSHIP 49.5M 2026

€65,000,000
FLAG - CAYMAN ISLANDS

MOTOR YACHT

PROJECT FUN

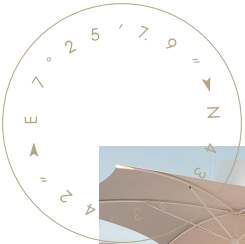

PROJECT FUN is a 49.5-meter custom motor yacht currently under construction at **Feadship**, with delivery scheduled for March 2026. Built entirely in aluminium and engineered with a diesel-electric propulsion system and Schottel thrusters, the yacht offers exceptional fuel efficiency, minimal vibration, and quiet operation. Compatible with HVO fuel and fully compliant with IMO Tier III standards, she represents the latest in environmentally conscious superyacht design.

Her sleek exterior is the work of De Voogt Naval Architects, while the interior was created by Marty Lowe Design to evoke a warm, organic atmosphere. A carefully chosen palette of natural materials and textures, paired with panoramic windows and thoughtfully planned lighting, gives the interior a sense of openness and calm. The main deck features a spacious saloon that blends lounge and dining areas, flowing effortlessly out to the aft deck, where guests will find a Jacuzzi, alfresco dining space, and fold-down balconies that transform into a beach club right at the water's edge.

Accommodation is provided for up to ten guests across five cabins, including a full-beam owner's suite with panoramic views, a private study, and a serene ensuite bathroom. Four guest cabins on the lower deck offer privacy and comfort, while the crew quarters are laid out for eight staff, including a separate captain's cabin, and include direct access to service areas to ensure smooth operation.

The yacht's outdoor decks are designed for both active living and total relaxation. The sun deck offers a bar, barbecue, large sunpads, and an open-air cinema screen, while the aft swim platform allows easy access to the water. For extended cruising, **PROJECT FUN** offers a top speed of 15 knots, a cruising speed of 12 knots, and a range of up to 4,000 nautical miles. Underway, onboard noise levels remain remarkably low - between 42 and 56 decibels - ensuring a tranquil experience at sea.

Currently in the advanced stages of construction, the hull and superstructure are complete, primary systems are installed, and outfitting is well underway. Launch is expected in November 2025, with delivery in early 2026.

PROJECT FUN presents a rare opportunity to acquire a new-generation **Feadship** of under 50 meters without the extended lead time. With its contemporary styling, low environmental footprint, and refined living spaces, it offers an ideal blend of innovation, luxury, and comfort for discerning owners.

[see more information about M/Y PROJECT FUN at www.nauyachts.com](http://www.nauyachts.com)

SPECIFICATION

SHIPYARD, MODEL	Feadship 50M
BUILT	2026
LENGTH	49.5 m
WATERLINE LENGTH	49.2 m
HULL CONFIGURATION	DISPLACEMENT
BEAM	9 m
RANGE	4000
DRAFT	2.25 m
GROSS TONNAGE	499 GT
YACHT CLASS	BUREAU VERITAS
CABINS	5+4
MASTER CABIN	MAIN DECK
GUESTS	10
BERTHS	10+8
CREW	8
HEADS	7+4

EXTERIOR DESIGN	FEADSHIP DE VOOGT NAVAL ARCHITECTS
INTERIOR DESIGN	MARTY LOWE
HULL	ALUMINUM
SUPERSTRUCTURE	ALUMINIUM
ENGINES	2 x John Deere 650 h.p.
TYPE OF DRIVE	SHAFT LINE
ENGINE HOURS	N/A
MAXIMUM SPEED	15 kn
CRUSING SPEED	12 kn
FUEL CONSUMPTION AT ECONOMICAL SPEED	N/A
FUEL	51100 l
GREY WATER	N/A
BLACK WATER	N/A
FRESH WATER	117900 l
DISPLACEMENT	N/A

[see more information about M/Y PROJECT FUN at www.nauyachts.com](http://www.nauyachts.com)



EXTERIOR FEADSHIP 50M 2026 PROJECT FUN

M/Y PROJECT FUN



EXTERIOR FEADSHIP 50M 2026 PROJECT FUN

M/Y PROJECT FUN



EXTERIOR FEADSHIP 50M 2026 PROJECT FUN

M/Y PROJECT FUN



AFT AREA

M/Y PROJECT FUN



BEACH CLUB

M/Y PROJECT FUN



EXTERIOR FEADSHIP 50M 2026 PROJECT FUN

M/Y PROJECT FUN



EXTERIOR FEADSHIP 50M 2026 PROJECT FUN

M/Y PROJECT FUN



EXTERIOR FEADSHIP 50M 2026 PROJECT FUN

M/Y PROJECT FUN

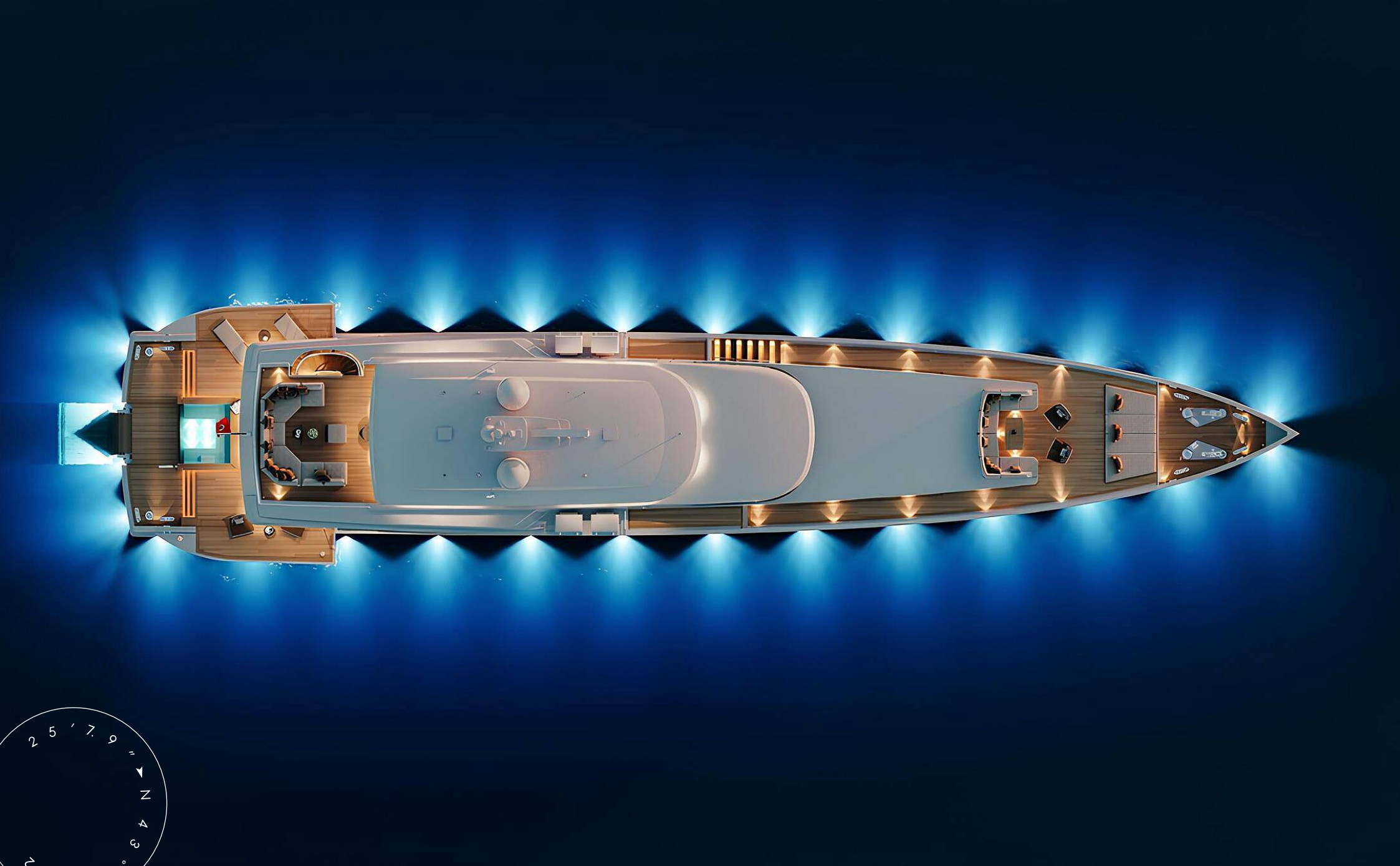

EXTERIOR FEADSHIP 50M 2026 PROJECT FUN

M/Y PROJECT FUN



AFT UPPER DECK LOUNGE AREA

M/Y PROJECT FUN



AFT MAIN DECK DINING AREA

M/Y PROJECT FUN



BOW LOUNGE AREA

M/Y PROJECT FUN



AFT MAIN DECK LOUNGE AREA

M/Y PROJECT FUN



BEACH CLUB

M/Y PROJECT FUN



MAIN SALON LOUNGE AREA

M/Y PROJECT FUN



MAIN SALON LOUNGE AREA

M/Y PROJECT FUN



MAIN SALON LOUNGE AREA

M/Y PROJECT FUN



MAIN SALON DINING AREA

M/Y PROJECT FUN



MAIN SALON DINING AREA

M/Y PROJECT FUN



MAIN SALON DINING AREA

M/Y PROJECT FUN



MAIN SALON DINING AREA

M/Y PROJECT FUN



MASTER CABIN

M/Y PROJECT FUN



MAKE-UP TABLE IN MASTER CABIN

M/Y PROJECT FUN



MASTER CABIN

M/Y PROJECT FUN



MASTER CABIN

M/Y PROJECT FUN



MASTER CABIN

M/Y PROJECT FUN



MASTER BATHROOM

M/Y PROJECT FUN



MASTER BATHROOM

M/Y PROJECT FUN



MASTER CABIN DRESSING ROOM

M/Y PROJECT FUN



MASTER CABIN DRESSING ROOM

M/Y PROJECT FUN



STAIRS FROM MD TO LD

M/Y PROJECT FUN



STAIRS FROM MD TO LD

M/Y PROJECT FUN



VIP CABIN

M/Y PROJECT FUN



VIP CABIN

M/Y PROJECT FUN



VIP CABIN

M/Y PROJECT FUN



VIP BATHROOM

M/Y PROJECT FUN



VIP BATHROOM

M/Y PROJECT FUN



VIP BATHROOM

M/Y PROJECT FUN

General Arrangement

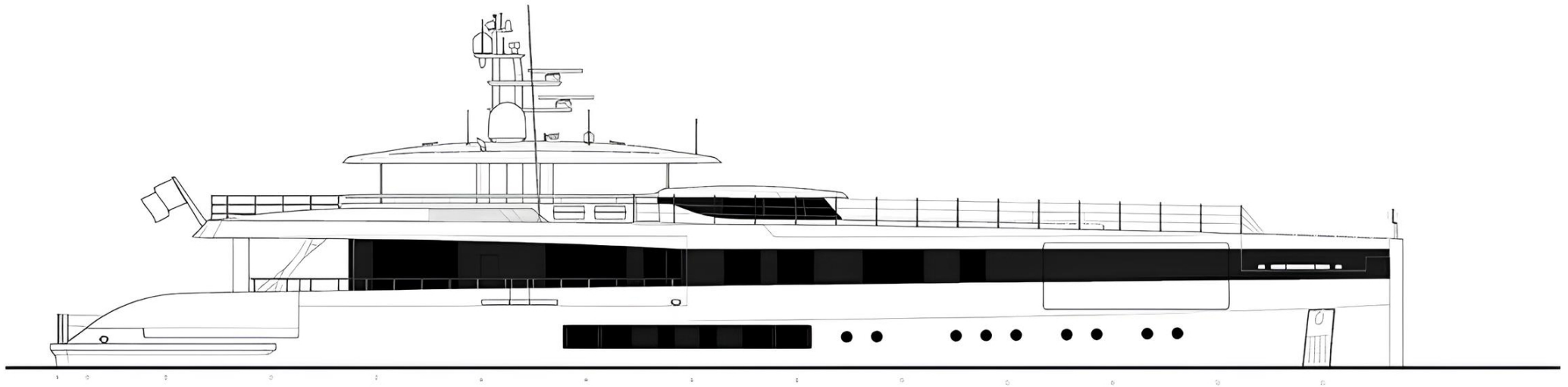

PROFILE

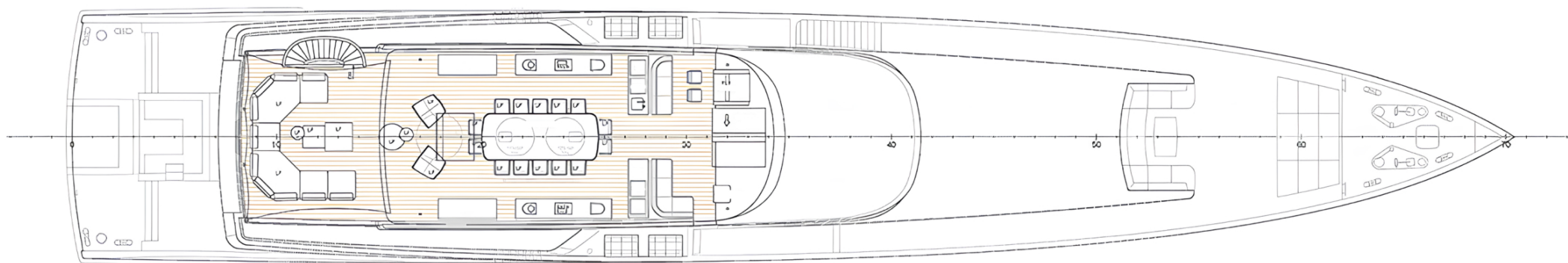

UPPER DECK

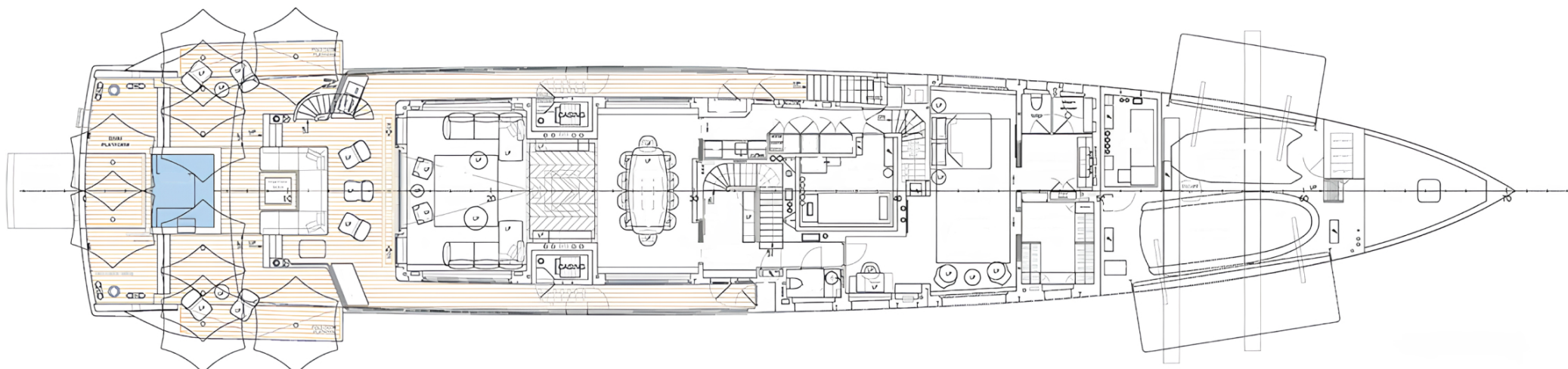

MAIN DECK

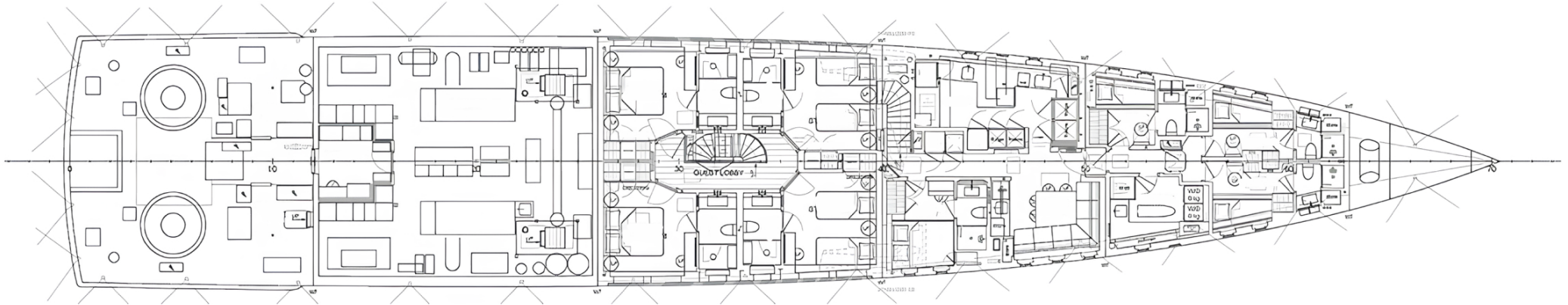

LOWER DECK



KIRILL KUATOV

+377 607 93 15 20

+39 333 576 44 44

 [Send e-mail](#)

 WhatsApp

 Telegram