



Brokerage

NAU
YACHTS

STELLA DEL NORD

MOTOR YACHT CANTIERE DELLE MARCHE 26.1M 2015

€7,250,000

FLAG - UNITED KINGDOM

MOTOR YACHT

STELLA DEL NORD

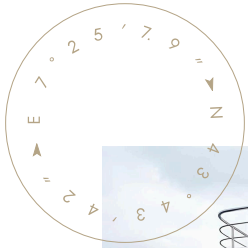

STELLA DEL NORD is a 26.1-metre explorer motor yacht built in 2015 by **Cantiere delle Marche** as part of the renowned Darwin 86 series. Featuring a steel hull and aluminium superstructure, she is designed for long-range cruising in all weather conditions, with a beam of 7.43 metres and naval architecture focused on stability, reliability, and energy efficiency.

Powered by twin CAT C12 diesel engines (385 hp each), **STELLA DEL NORD** cruises comfortably at 9 knots, reaching a top speed of 12 knots. Her efficient hull design delivers a transoceanic range of over 3,300 nautical miles, making her ideal for extended autonomous voyages.

She accommodates up to 10 guests in four en-suite staterooms, with interiors thoughtfully designed for comfort and practicality during long stays onboard. Large windows flood the saloons with natural light, while open deck areas and al fresco dining spaces offer excellent connection to the sea.

Teak decks throughout add to the yacht's traditional explorer character, and the layout is optimized for both private cruising and adventure-oriented programs. Built to the standards of ocean-going expedition vessels, **STELLA DEL NORD** is in excellent technical condition and ready to cruise.

Combining seakeeping ability, autonomy, and onboard comfort, **STELLA DEL NORD** is a reliable platform for owners seeking to explore remote destinations in safety and style.

[see more information about M/Y STELLA DEL NORD at www.nauyachts.com](http://www.nauyachts.com)

SPECIFICATION

SHIPYARD, MODEL	Cantiere Delle Marche Darwin 86
BUILT	2015
LENGTH	26.1 m
WATERLINE LENGTH	22.9 m
HULL CONFIGURATION	DISPLACEMENT
BEAM	7.43 m
RANGE	4000
DRAFT	2.42 m
GROSS TONNAGE	195 GT
YACHT CLASS	C  HULL • MACH Y
CABINS	4+2
MASTER CABIN	LOWER DECK
GUESTS	8
BERTHS	8+4
CREW	4
HEADS	5+2

EXTERIOR DESIGN	HYDRO TEC
INTERIOR DESIGN	HYDRO TEC
HULL	STEEL
SUPERSTRUCTURE	ALUMINIUM
ENGINES	2 x CAT C12 385 h.p.
TYPE OF DRIVE	SHAFT LINE
ENGINE HOURS	N/A
MAXIMUM SPEED	11.5 kn
CRUISING SPEED	10 kn
FUEL CONSUMPTION AT ECONOMICAL SPEED	~ 146 l/h
FUEL	38324 l
GREY WATER	6366 l
BLACK WATER	985 l
FRESH WATER	3400 l
DISPLACEMENT	210

[see more information about M/Y STELLA DEL NORD at www.nauyachts.com](http://www.nauyachts.com)



EXTERIOR CANTIERE DELLE MARCHE DARWIN
86 2015 MY STELLA DEL NORD

M/Y STELLA DEL NORD



EXTERIOR CANTIERE DELLE MARCHE DARWIN
86 2015 MY STELLA DEL NORD

M/Y STELLA DEL NORD



AFT AREA

M/Y STELLA DEL NORD



AFT MAIN DECK DINING AREA

M/Y STELLA DEL NORD



AFT UPPER DECK DINING AREA

M/Y STELLA DEL NORD



BOW LOUNGE AREA

M/Y STELLA DEL NORD



SUNDECK LOUNGE AREA

M/Y STELLA DEL NORD



SECOND HELM STATION

M/Y STELLA DEL NORD



UPPER DECK SALOON

M/Y STELLA DEL NORD



MAIN SALON LOUNGE AREA

M/Y STELLA DEL NORD



MAIN SALON LOUNGE AREA

M/Y STELLA DEL NORD



MAIN SALON DINING AREA

M/Y STELLA DEL NORD



MAIN SALON DINING AREA

M/Y STELLA DEL NORD



MASTER CABIN

M/Y STELLA DEL NORD



MASTER CABIN

M/Y STELLA DEL NORD



MASTER CABIN

M/Y STELLA DEL NORD



MASTER BATHROOM

M/Y STELLA DEL NORD



GUEST CABIN

M/Y STELLA DEL NORD



GUEST BATHROOM

M/Y STELLA DEL NORD



VIP CABIN

M/Y STELLA DEL NORD



GALLEY

M/Y STELLA DEL NORD



MAIN HELM STATION

M/Y STELLA DEL NORD

General Arrangement

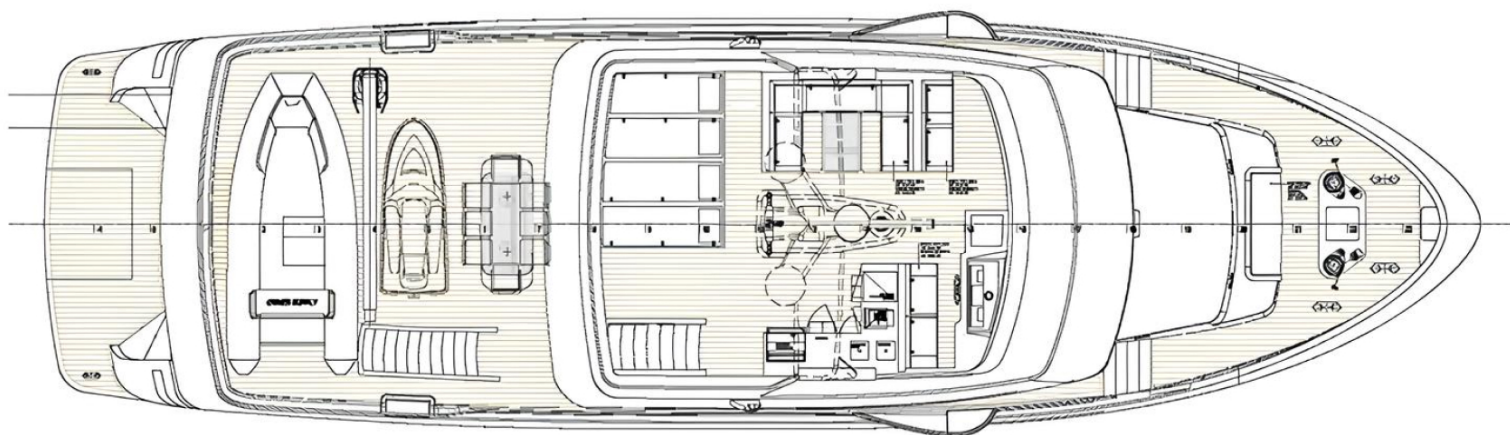

SUNDECK

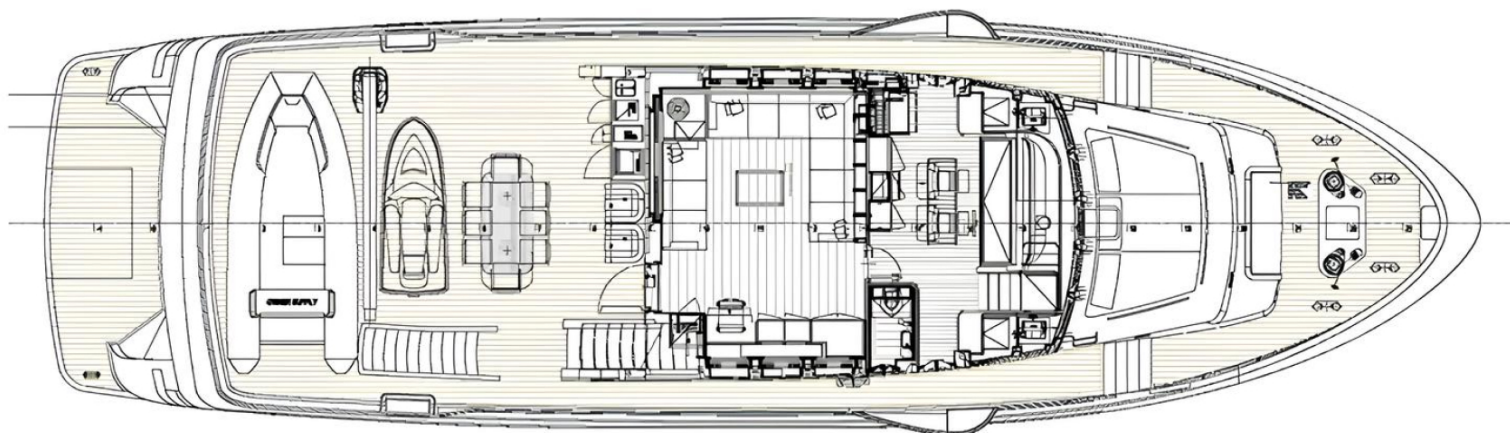

UPPER DECK

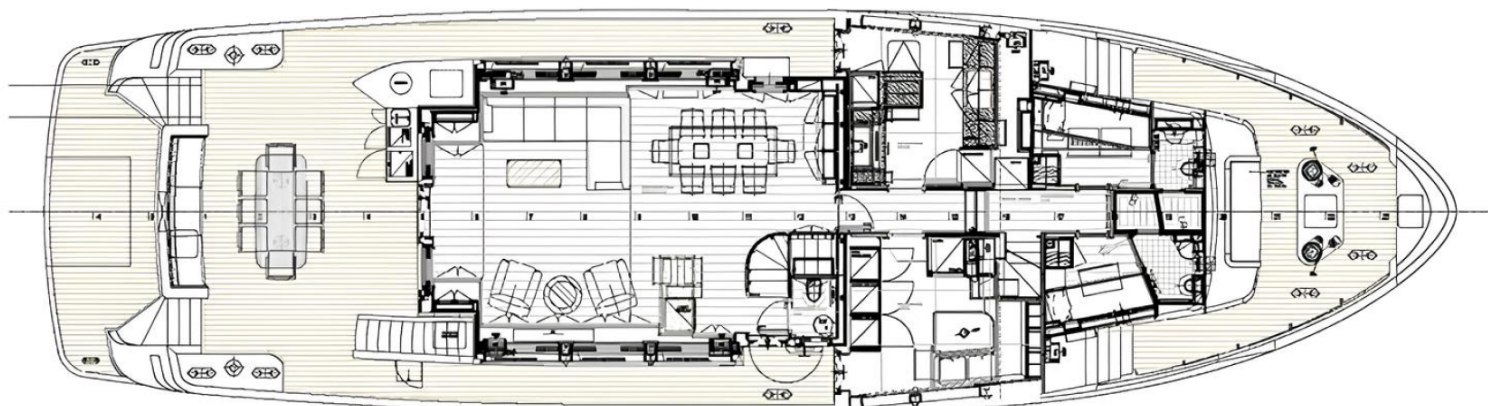

MAIN DECK



LOWER DECK



KIRILL KUATOV

+377 607 93 15 20

+39 333 576 44 44

 [Send e-mail](#)

 WhatsApp

 Telegram

[More information about M/Y STELLA DEL NORD at www.nauyachts.com](#)

[Watch video](#)