



Brokerage

NAU  
YACHTS

TRIDENT

MOTOR YACHT    LEADSHIP 65.22M    2009

€63,000,000

FLAG - MARSHALL ISLANDS



MOTOR YACHT

## TRIDENT



**TRIDENT** is a 65.22-meter motor yacht built by the renowned Dutch shipyard **Feadship** in 2009. Designed by Donald Starkey in collaboration with De Voogt Naval Architects, she combines timeless elegance, proven oceangoing capability, and world-class Dutch engineering. Her steel hull and aluminum superstructure ensure strength, stability, and performance.

The yacht accommodates up to 12 guests in 8 luxurious staterooms. The full-beam master suite on the main deck features a king-size bed, his-and-hers bathrooms, and a spacious walk-in wardrobe. Additional accommodations include one VIP cabin with a king-size bed, four VIP guest cabins, and two twin-bed cabins. An experienced crew of 16 ensures impeccable service throughout every voyage.

**TRIDENT's** expansive exterior decks are designed for relaxation and socializing, featuring a jacuzzi on the sun deck, generous lounging areas, and alfresco dining spaces. A fully equipped gym provides onboard wellness, while a guest elevator and stabilization systems ensure maximum comfort underway and at anchor.

Powered by twin MTU 16V4000 M60R diesel engines, **TRIDENT** cruises comfortably at 12 knots and reaches a top speed of 16 knots. With a range of approximately 4,900 nautical miles, she is ideal for extended transoceanic cruising without compromise. Boasting an impressive gross tonnage of 1,400 GT, a beam of 11.4 meters, and generous tank capacities for fuel and freshwater, **TRIDENT** offers outstanding onboard volume and autonomy. She represents a rare opportunity to acquire a pedigree Feadship with global capabilities and timeless appeal.

[see more information about M/Y TRIDENT at www.nauyachts.com](http://www.nauyachts.com)

# SPECIFICATION

|                    |              |
|--------------------|--------------|
| SHIPYARD, MODEL    | Feadship 65M |
| BUILT              | 2009         |
| LENGTH             | 65.22 m      |
| WATERLINE LENGTH   | 59.43 m      |
| HULL CONFIGURATION | DISPLACEMENT |
| BEAM               | 11.4 m       |
| RANGE              | 4900         |
| DRAFT              | 3.65 m       |
| GROSS TONNAGE      | 1400 GT      |
| YACHT CLASS        | LLOYD'S      |
| CABINS             | 8+8          |
| MASTER CABIN       | MAIN DECK    |
| GUESTS             | 16           |
| BERTHS             | 16+15        |
| CREW               | 15           |
| HEADS              | 10+8         |

|                                      |                      |
|--------------------------------------|----------------------|
| EXTERIOR DESIGN                      | DONALD STARKEY       |
| INTERIOR DESIGN                      | DONALD STARKEY       |
| HULL                                 | STEEL                |
| SUPERSTRUCTURE                       | ALUMINIUM            |
| ENGINES                              | 2 x MTU 16V4000 M60R |
| TYPE OF DRIVE                        | SHAFT LINE           |
| ENGINE HOURS                         | 7212 h               |
| MAXIMUM SPEED                        | 16 kn                |
| CRUISING SPEED                       | 12 kn                |
| FUEL CONSUMPTION AT ECONOMICAL SPEED | ~ 374 l/h            |
| FUEL                                 | 157000 l             |
| GREY WATER                           | N/A                  |
| BLACK WATER                          | N/A                  |
| FRESH WATER                          | 37000 l              |
| DISPLACEMENT                         | N/A                  |

[see more information about M/Y TRIDENT at www.nauyachts.com](http://www.nauyachts.com)





EXTERIOR FEADSHIP 65M 2009 MY TRIDENT

M/Y TRIDENT





EXTERIOR FEADSHIP 65M 2009 MY TRIDENT

M/Y TRIDENT





EXTERIOR FEADSHIP 65M 2009 MY TRIDENT

M/Y TRIDENT





JACUZZI ON THE BOW

M/Y TRIDENT





BOW AREA

M/Y TRIDENT





STARBOARD

M/Y TRIDENT





AFT UPPER DECK DINING AREA

M/Y TRIDENT





AFT UPPER DECK DINING AREA

M/Y TRIDENT





AFT MAIN DECK DINING AREA

M/Y TRIDENT





UPPER DECK SALOON

M/Y TRIDENT





UPPER DECK SALOON

M/Y TRIDENT





MAIN SALON LOUNGE AREA

M/Y TRIDENT





MAIN SALON DINING AREA

M/Y TRIDENT





MASTER CABIN

M/Y TRIDENT





MASTER BATHROOM

M/Y TRIDENT





MASTER BATHROOM

M/Y TRIDENT





VIP CABIN

M/Y TRIDENT





VIP CABIN

M/Y TRIDENT





VIP CABIN

M/Y TRIDENT





VIP CABIN

M/Y TRIDENT





GUEST CABIN

M/Y TRIDENT





GUEST CABIN

M/Y TRIDENT





GUEST CABIN

M/Y TRIDENT



# General Arrangement



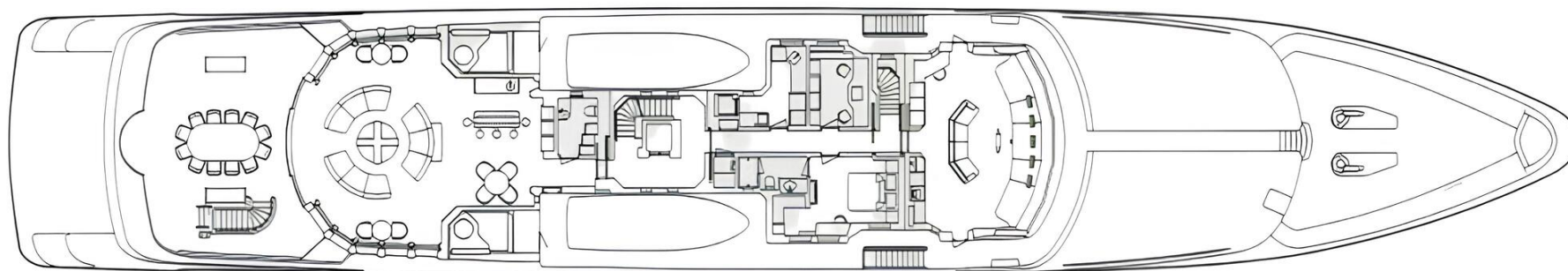

UPPER DECK



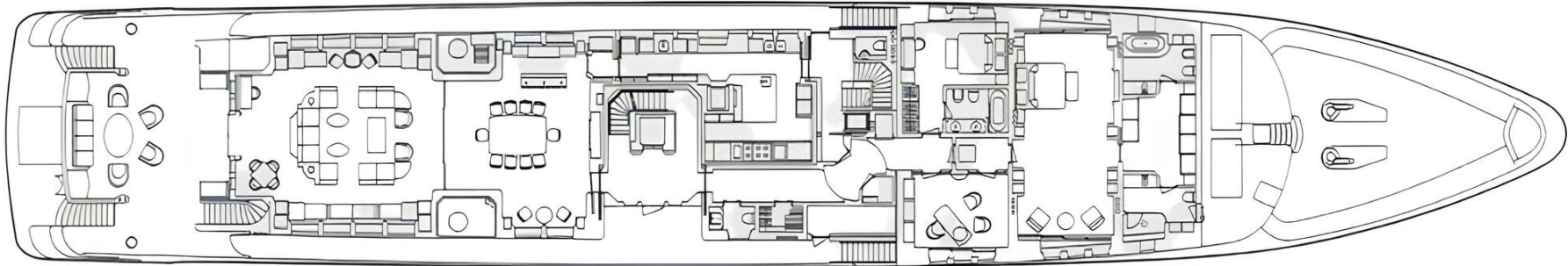

MAIN DECK



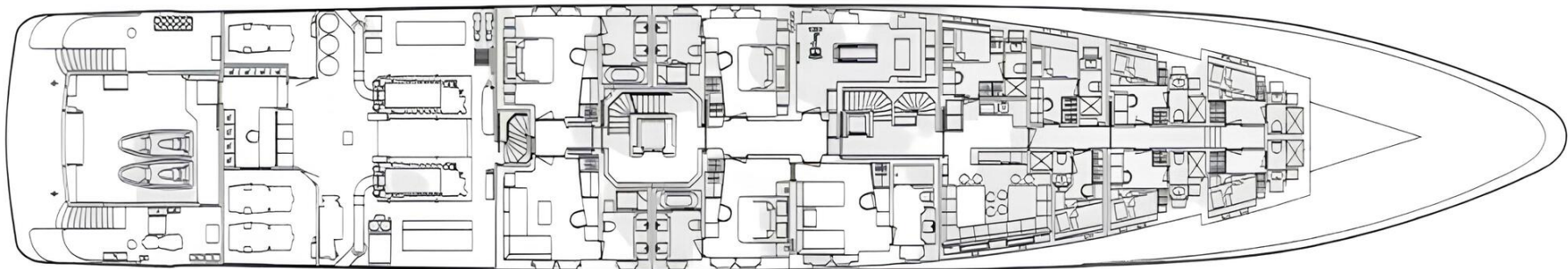

LOWER DECK





## KIRILL KUATOV

+377 607 93 15 20

+39 333 576 44 44

 [Send e-mail](#)

 WhatsApp

 Telegram

[More information about M/Y TRIDENT at www.nauyachts.com](#)

[Watch video](#)