



New Build

NAU
YACHTS

AB 80

MOTOR YACHT AB YACHTS 25.2M 2025

FLAG -

MOTOR YACHT

AB 80

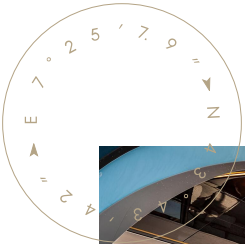

The 25-meter **AB 80** is designed for discerning owners, embodying luxury with a perfect blend of speed, safety, and comfort. Its sporty design is complemented by a layout that offers seamless transitions between indoor and outdoor spaces, making the yacht feel larger than its actual size. The main salon opens to a spacious cockpit with a generous dining area and large sun loungers. The flybridge features a unique "open roof" concept, ideal for dining under the stars or enjoying a secluded, sunlit retreat.

With an overall length of 25.20 meters and a beam of 6.50 meters, the **AB 80** maximizes space and volume. A shallow draft of 1.30 meters allows easy access to shallow waters. The yacht is equipped with a 9,500-liter fuel tank and a 2,000-liter water tank.

Fast, elegant, and innovative, the **AB 80** is packed with amenities and delivers exceptional performance. Powered by three MAN V12-2000 engines, each generating 2000 horsepower (1471 kW at 2300 RPM), and featuring three MJP waterjets and a SEAKEEPER 18 stabilization system, the yacht reaches a top speed of 55 knots and cruises comfortably at 49 knots, with a range of approximately 500 nautical miles.

Combining timeless elegance with modern innovation, the **AB 80** sets new standards in luxury yachting.

[see more information about M/Y AB 80 at www.nauyachts.com](http://www.nauyachts.com)

SPECIFICATION

SHIPYARD, MODEL	AB Yachts AB 80
BUILT	2025
LENGTH	25.2 m
WATERLINE LENGTH	23.97 m
HULL CONFIGURATION	PLANING
BEAM	6.5 m
RANGE	450
DRAFT	1.3 m
GROSS TONNAGE	100 GT
YACHT CLASS	RINA
CABINS	3+1
MASTER CABIN	LOWER DECK
GUESTS	8
BERTHS	8+2
CREW	2
HEADS	3+1

EXTERIOR DESIGN	NEXT YACHT GROUP
INTERIOR DESIGN	MARCO CASAMONTI
HULL	GRP
SUPERSTRUCTURE	GRP
ENGINES	3 x MAN V12 2000 h.p.
TYPE OF DRIVE	JET
ENGINE HOURS	N/A
MAXIMUM SPEED	55 kn
CRUISING SPEED	49 kn
FUEL CONSUMPTION AT ECONOMICAL SPEED	N/A
FUEL	9000 l
GREY WATER	N/A
BLACK WATER	N/A
FRESH WATER	1800 l
DISPLACEMENT	75

[see more information about M/Y AB 80 at www.nauyachts.com](http://www.nauyachts.com)



EXTERIOR AB YACHTS AB 80 2025

M/Y AB 80



EXTERIOR AB YACHTS AB 80 2025

M/Y AB 80



EXTERIOR AB YACHTS AB 80 2025

M/Y AB 80



EXTERIOR AB YACHTS AB 80 2025

M/Y AB 80



EXTERIOR AB YACHTS AB 80 2025

M/Y AB 80



EXTERIOR AB YACHTS AB 80 2025

M/Y AB 80



AFT MAIN DECK DINING AREA

M/Y AB 80



AFT MAIN DECK DINING AREA

M/Y AB 80



AFT MAIN DECK DINING AREA

M/Y AB 80



ENTRANCE TO THE MAIN SALON

M/Y AB 80



MAIN SALON

M/Y AB 80



MAIN HELM STATION

M/Y AB 80



MASTER CABIN

M/Y AB 80



MASTER CABIN

M/Y AB 80

General Arrangement

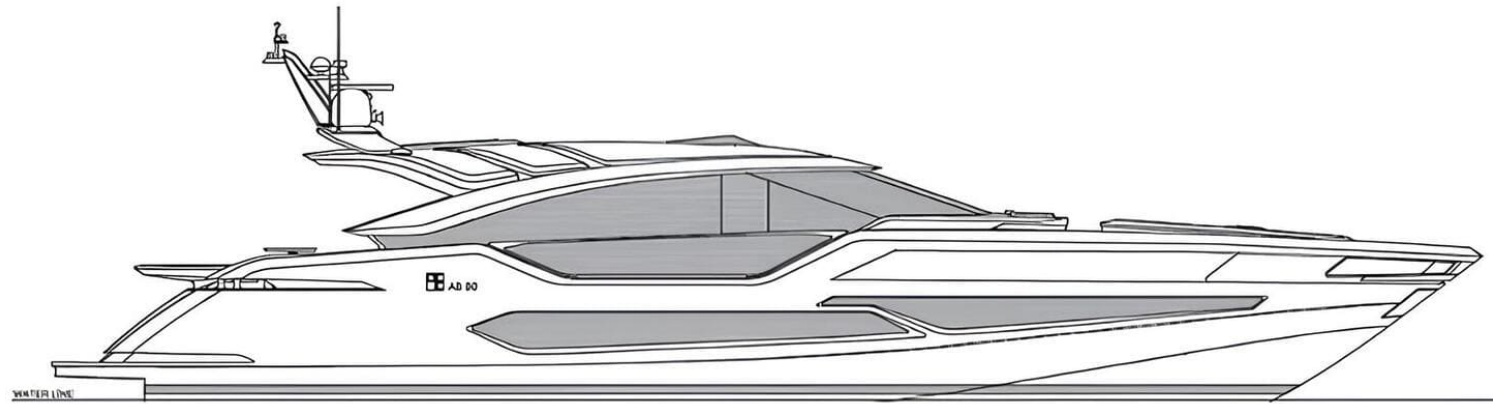

PROFILE

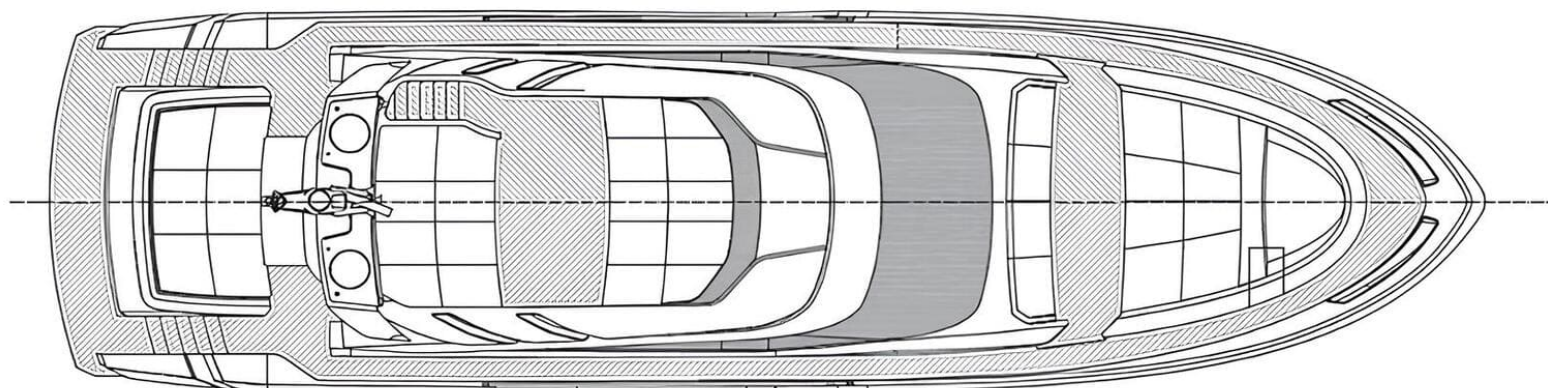

FLYBRIDGE

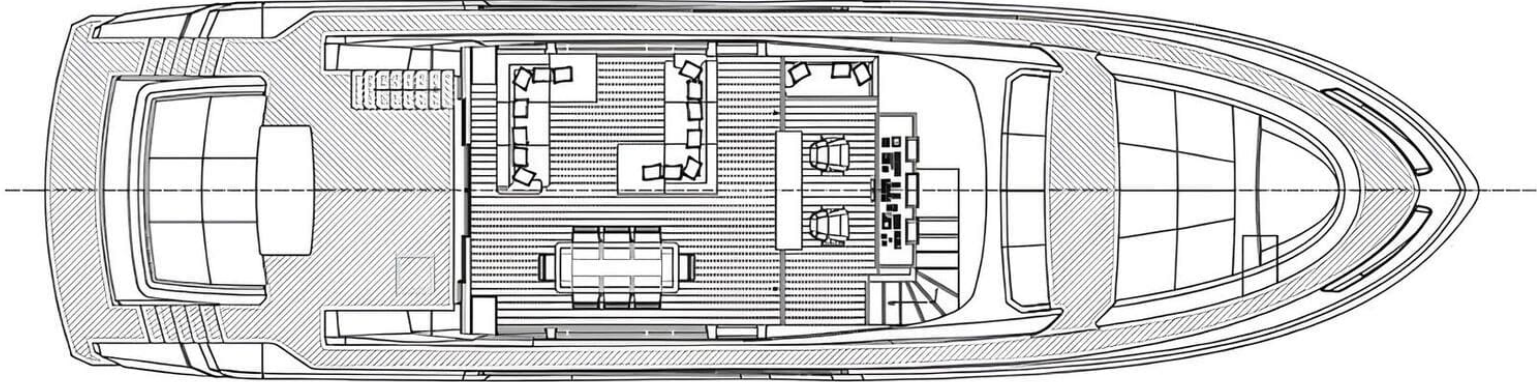

MAIN DECK

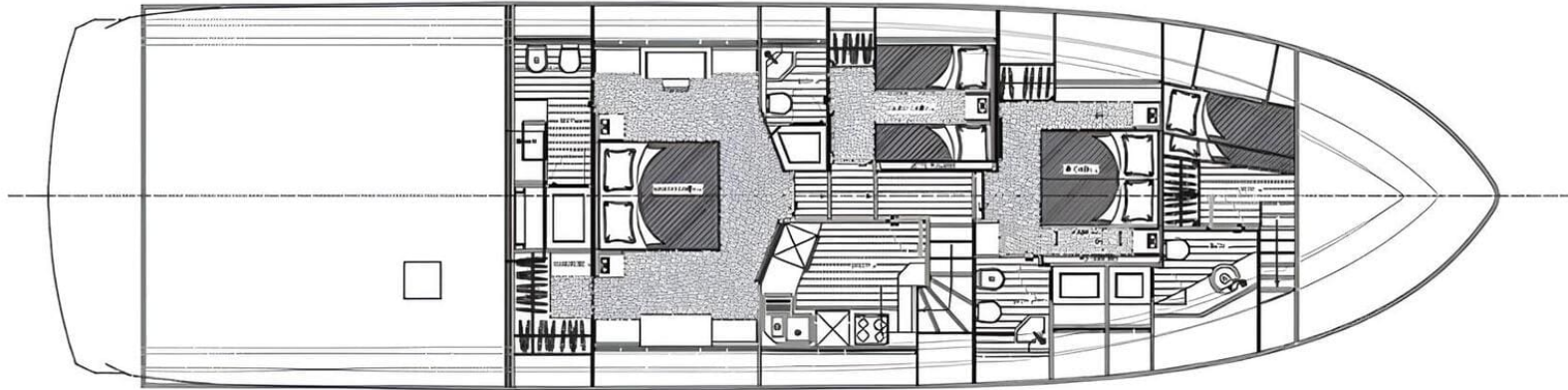

LOWER DECK



KIRILL KUATOV

+377 607 93 15 20

+39 333 576 44 44

 [Send e-mail](#)

 WhatsApp

 Telegram