



Brokerage

NAU
YACHTS

LIBERTY

MOTOR YACHT ISA YACHTS 49.95M 2011

€15,150,000
FLAG - CAYMAN ISLANDS

MOTOR YACHT

LIBERTY

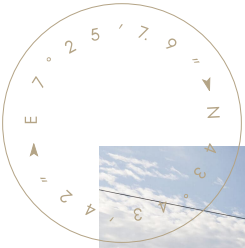

LIBERTY is a 50-metre motor yacht built by **ISA Yachts** in 2011 and extensively refitted in 2021. She combines exceptional craftsmanship, reliable engineering, and a well-balanced design. Her sleek dark blue steel hull and silver aluminium superstructure create a contemporary and refined silhouette.

The yacht's exterior lines were penned by Andrea Vallicelli, showcasing clean, harmonious proportions. The expansive sundeck features a bar, barbecue, Jacuzzi, and generous lounge areas - ideal for relaxing or entertaining. Interior design by René van der Velden reflects a sophisticated modern style, blending light ash and rich walnut woods. Abundant natural light floods the living spaces through panoramic windows and skylights.

LIBERTY accommodates up to 13 guests across six cabins. The full-beam master suite is located on the main deck and boasts a private terrace, Jacuzzi, and walk-in wardrobe. The remaining guest cabins are situated on the lower deck, each with its own en-suite bathroom. A crew of nine is housed in separate quarters to ensure impeccable service and maximum privacy for guests.

Powered by twin MTU 12V 4000 M71 diesel engines, each delivering 2,480 hp, **LIBERTY** reaches a top speed of 17 knots and cruises comfortably at 12 knots. She offers an impressive range of up to 4,400 nautical miles, making her ideal for long-range cruising.

[see more information about M/Y LIBERTY at www.nauyachts.com](http://www.nauyachts.com)

SPECIFICATION

SHIPYARD, MODEL	ISA Yachts 50M
BUILT	2011
LENGTH	49.95 m
WATERLINE LENGTH	47.31 m
HULL CONFIGURATION	DISPLACEMENT
BEAM	9 m
RANGE	4400
DRAFT	2.55 m
GROSS TONNAGE	495 GT
YACHT CLASS	RINA
CABINS	6+6
MASTER CABIN	MAIN DECK
GUESTS	13
BERTHS	13+11
CREW	11
HEADS	8+6

EXTERIOR DESIGN	ANDREA VALLICELLI
INTERIOR DESIGN	RENE VAN DER VELDEN
HULL	STEEL
SUPERSTRUCTURE	ALUMINIUM
ENGINES	2 x MTU 12V 4000 M71 2480 h.p.
TYPE OF DRIVE	SHAFT LINE
ENGINE HOURS	5705 h
MAXIMUM SPEED	17 kn
CRUISING SPEED	12 kn
FUEL CONSUMPTION AT ECONOMICAL SPEED	~ 220 l/h
FUEL	87000 l
GREY WATER	N/A
BLACK WATER	N/A
FRESH WATER	15000 l
DISPLACEMENT	416

[see more information about M/Y LIBERTY at www.nauyachts.com](http://www.nauyachts.com)



EXTERIOR ISA YACHTS 500 2011 MY LIBERTY

M/Y LIBERTY



EXTERIOR ISA YACHTS 500 2011 MY LIBERTY

M/Y LIBERTY



EXTERIOR ISA YACHTS 500 2011 MY LIBERTY

M/Y LIBERTY



EXTERIOR ISA YACHTS 500 2011 MY LIBERTY

M/Y LIBERTY



EXTERIOR ISA YACHTS 500 2011 MY LIBERTY

M/Y LIBERTY



EXTERIOR ISA YACHTS 500 2011 MY LIBERTY

M/Y LIBERTY



BOW LOUNGE AREA

M/Y LIBERTY



SUNDECK LOUNGE AREA

M/Y LIBERTY



PORTSIDE

M/Y LIBERTY



STARBOARD

M/Y LIBERTY



AFT UPPER DECK LOUNGE AREA

M/Y LIBERTY



AFT MAIN DECK DINING AREA

M/Y LIBERTY



UPPER DECK SALOON

M/Y LIBERTY



UPPER DECK SALOON

M/Y LIBERTY



MAIN SALON LOUNGE AREA

M/Y LIBERTY



MAIN SALON LOUNGE AREA

M/Y LIBERTY



MAIN SALON DINING AREA

M/Y LIBERTY



MAIN SALON DINING AREA

M/Y LIBERTY



MASTER CABIN LOUNGE AREA

M/Y LIBERTY



MASTER CABIN LOUNGE AREA

M/Y LIBERTY



MASTER CABIN LOUNGE AREA

M/Y LIBERTY



MASTER CABIN

M/Y LIBERTY



MASTER CABIN

M/Y LIBERTY



MASTER CABIN

M/Y LIBERTY



MASTER CABIN

M/Y LIBERTY



MASTER BATHROOM

M/Y LIBERTY



VIP CABIN

M/Y LIBERTY



VIP BATHROOM

M/Y LIBERTY



VIP CABIN

M/Y LIBERTY



VIP BATHROOM

M/Y LIBERTY



GUEST CABIN

M/Y LIBERTY



GUEST BATHROOM

M/Y LIBERTY



GUEST CABIN

M/Y LIBERTY



GUEST BATHROOM

M/Y LIBERTY

General Arrangement

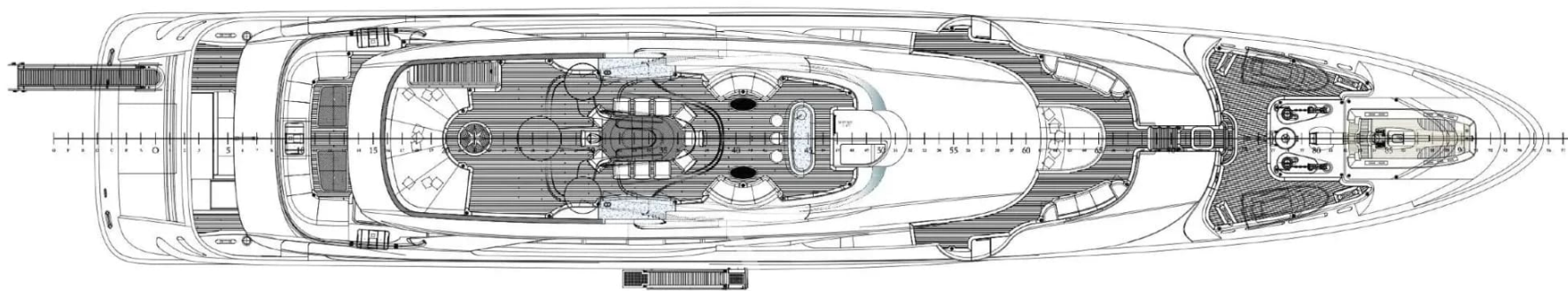

SUNDECK



UPPER DECK

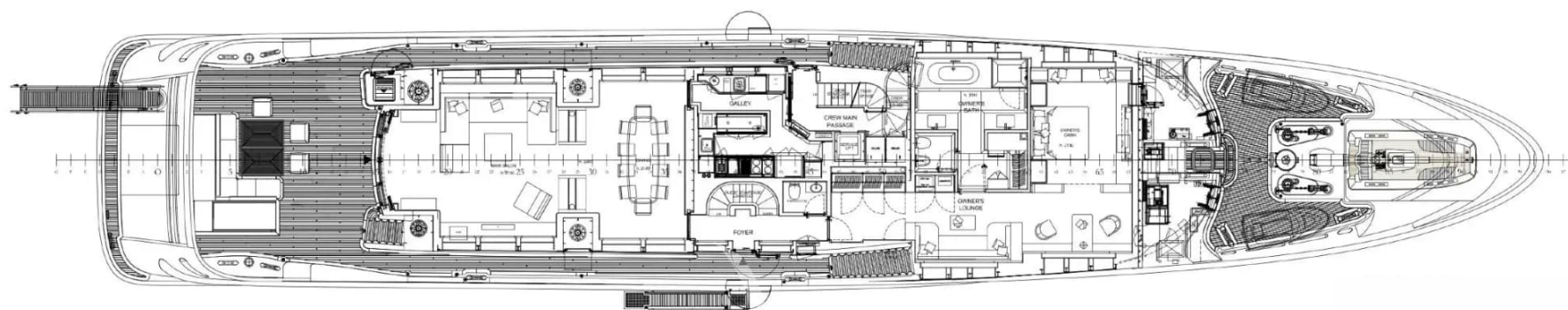

MAIN DECK

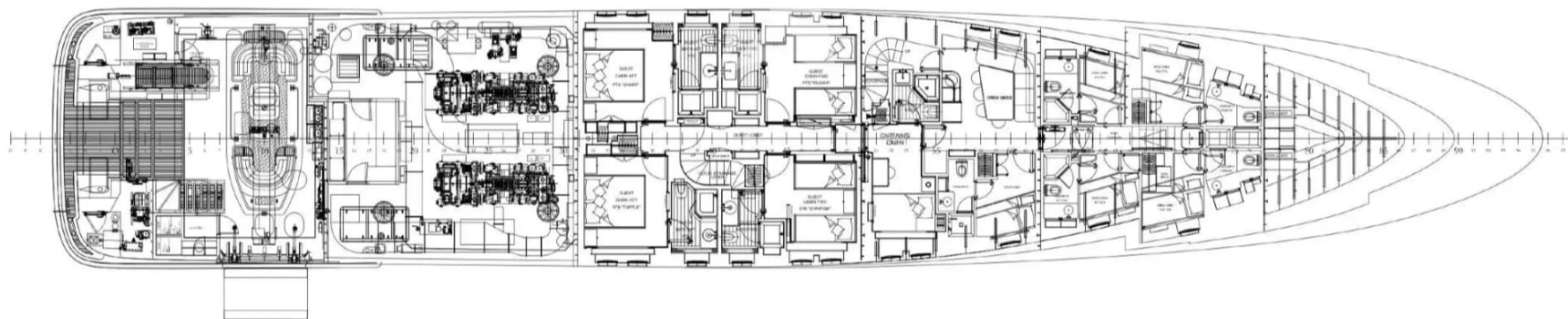

LOWER DECK



KIRILL KUATOV

+377 607 93 15 20

+39 333 576 44 44

 [Send e-mail](#)

 WhatsApp

 Telegram

[More information about M/Y LIBERTY at www.nauyachts.com](#)

[Watch video](#)