



New Build

NAU
YACHTS

SPORT 43M

MOTOR YACHT COLUMBUS YACHTS 43.1M 2027

FLAG -

MOTOR YACHT

SPORT 43M

Introducing the **SPORT 43**, featuring a lightweight aluminum hull and superstructure for exceptional performance and efficiency within a luxurious design, all under 500 GT. The **SPORT 43's** striking plumb-bow style with well-defined lines is complemented by soft edges, blending sporty features with attractive and welcoming spaces.

This semi-displacement model boasts a transatlantic range of over 3,000 nautical miles and a top speed of 20 knots, making it perfect for both high-speed cruising and long-distance voyages.



see more information about M/Y Sport 43M at www.nauyachts.com

SPECIFICATION

SHIPYARD, MODEL	Columbus Yachts Sport 43M
DELIVERY AT THE SHIPYARD	2027
LENGTH	43.1 m
WATERLINE LENGTH	N/A
HULL CONFIGURATION	SEMI-DISPLACEMENT
BEAM	8.2 m
RANGE	3000
DRAFT	1.8 m
GROSS TONNAGE	433 GT
YACHT CLASS	N/A
CABINS	5+4
MASTER CABIN	MAIN DECK
GUESTS	10
BERTHS	10+7
CREW	7
HEADS	7+5

EXTERIOR DESIGN	LUCA DINI DESIGN & ARCHITECTURE
INTERIOR DESIGN	LUCA DINI DESIGN & ARCHITECTURE
HULL	ALUMINUM
SUPERSTRUCTURE	ALUMINIUM
ENGINES	2 x MTU 12V 2000M96L
TYPE OF DRIVE	SHAFT LINE
ENGINE HOURS	N/A
MAXIMUM SPEED	20 kn
CRUSING SPEED	18 kn
FUEL CONSUMPTION AT ECONOMICAL SPEED	N/A
FUEL	N/A
GREY WATER	N/A
BLACK WATER	N/A
FRESH WATER	N/A
DISPLACEMENT	N/A

[see more information about M/Y Sport 43M at www.nauyachts.com](http://www.nauyachts.com)



EXTERIOR

M/Y SPORT 43M



EXTERIOR

M/Y SPORT 43M



EXTERIOR

M/Y SPORT 43M



EXTERIOR

M/Y SPORT 43M



EXTERIOR

M/Y SPORT 43M



INTERIOR

M/Y SPORT 43M

General Arrangement

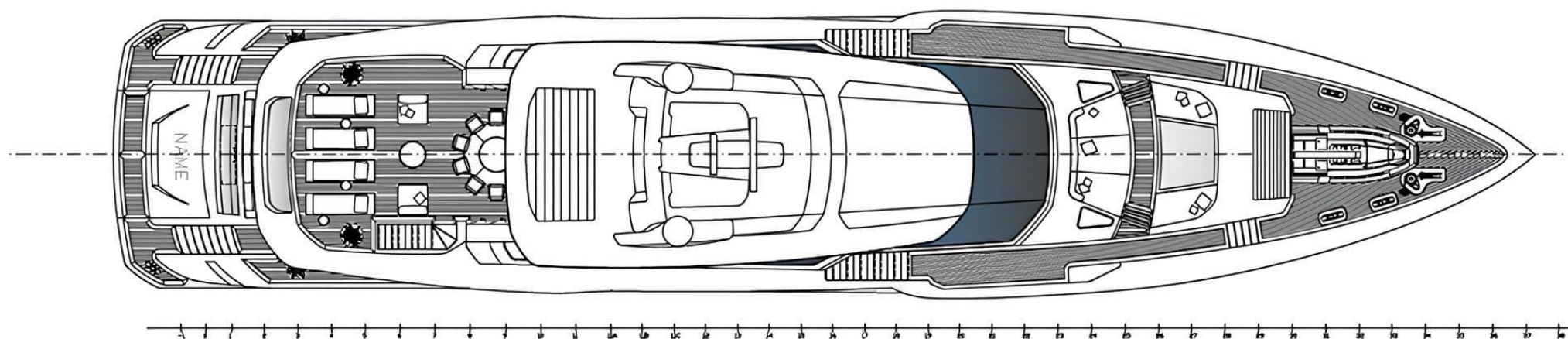

TOP VIEW

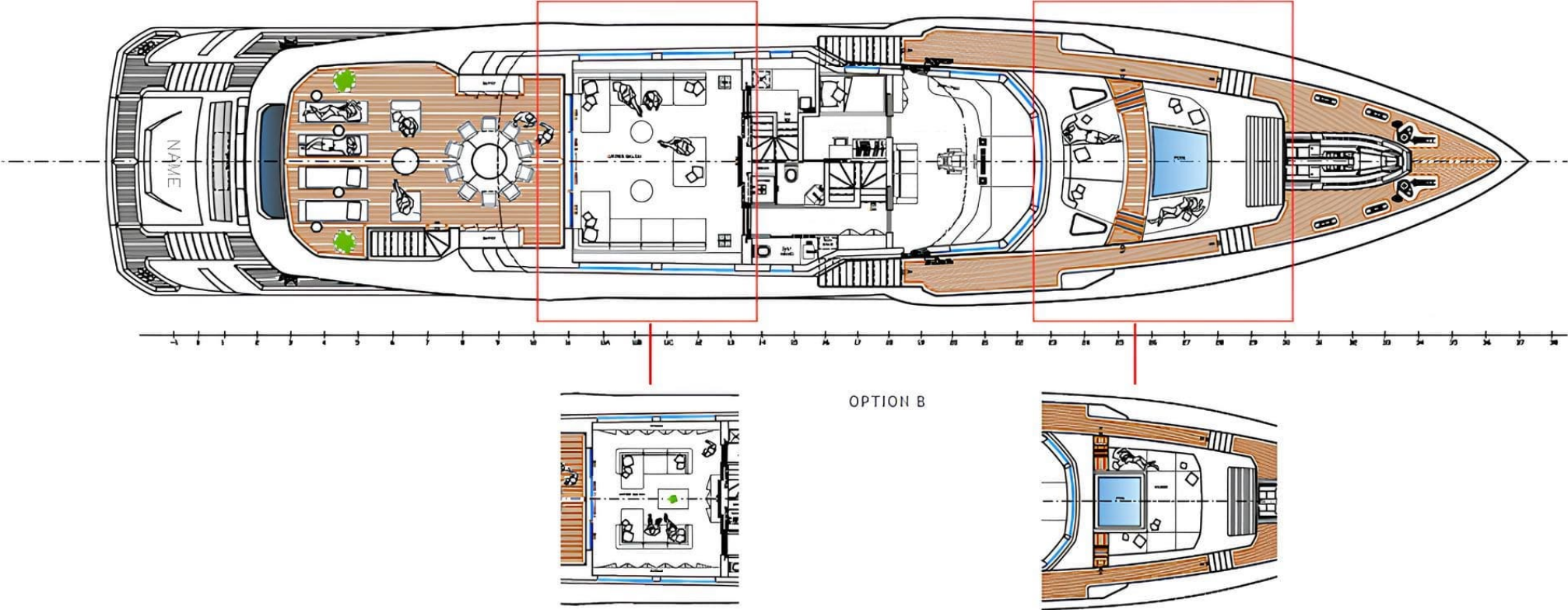

UPPER DECK

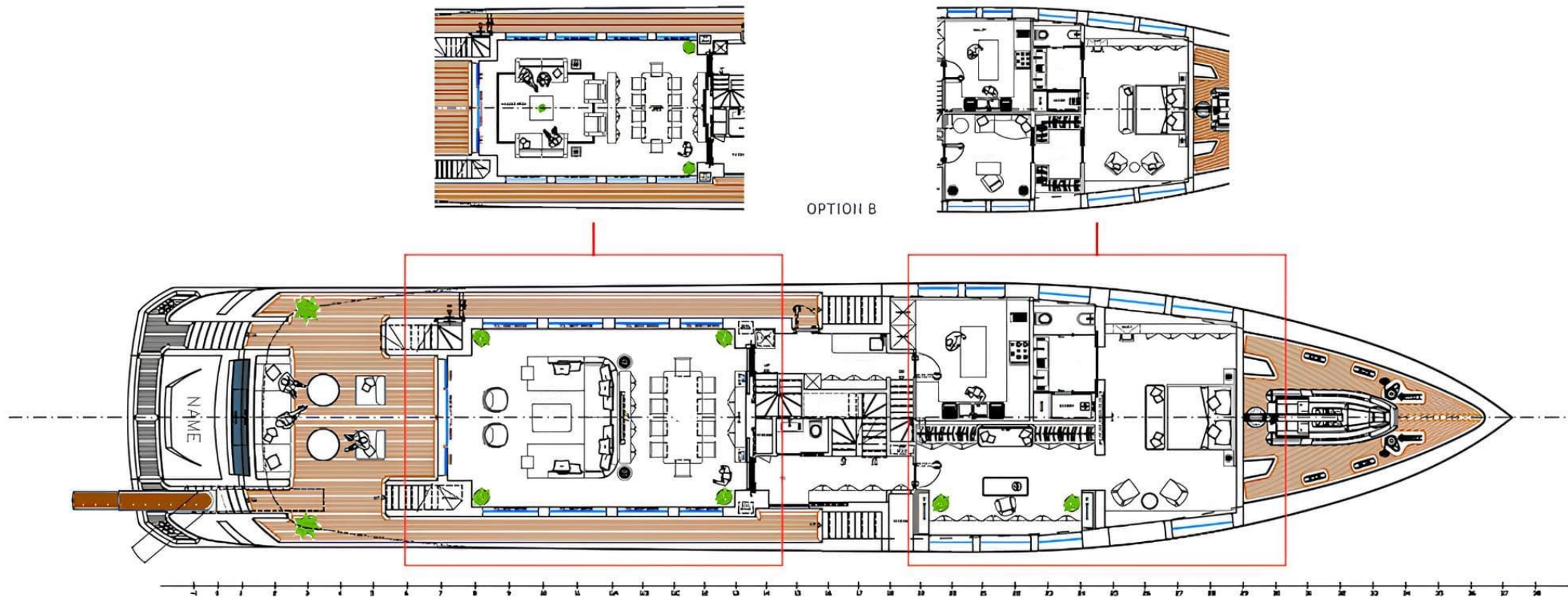

MAIN DECK

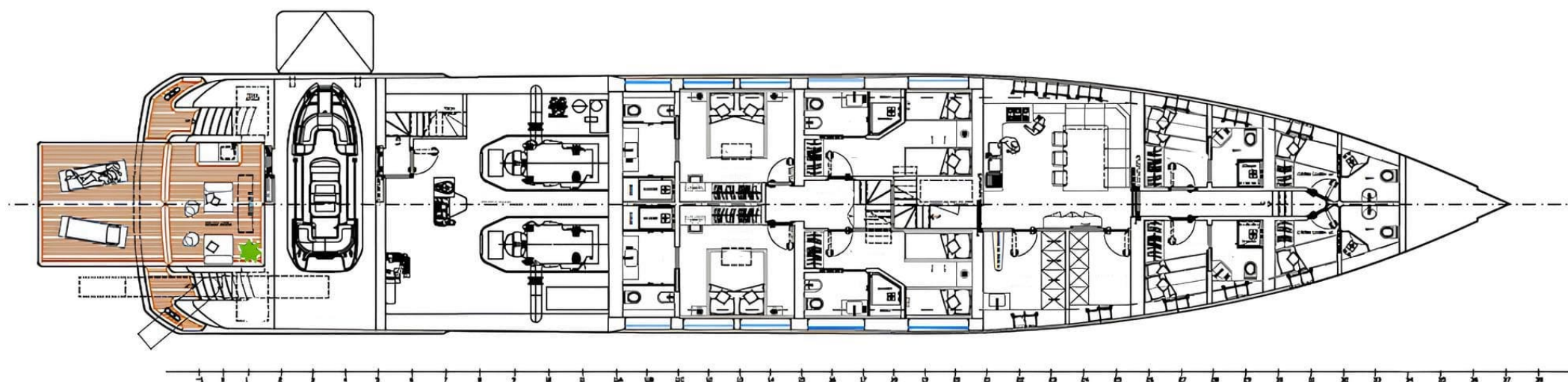

LOWER DECK



KIRILL KUATOV

+377 607 93 15 20

+39 333 576 44 44

 [Send e-mail](#)

 WhatsApp

 Telegram