



New Build

NAU
YACHTS

B88

MOTOR YACHT BERING 26.2M 2026

FLAG -

MOTOR YACHT

B88

The **B88** is a unique boat - its length is just under 24 meters according to the classification society RINA. With a length of 23.85 meters, her dimensions are officially recognized by MGN 280 as "Small Commercial Vessel". Given the configuration of the **B88** superyacht, she may just be the perfect vessel for charter.

Over 177 m² of interior space, approximately 43 m² of crew accommodation and almost 128 m² of technical spaces ensure that all 10 guests will have plenty of room for entertainment and relaxation, and if necessary, privacy. The crew of 5 will benefit from spacious spaces for work and relaxation.

A displacement of 225 metric tons provides the **B88** with enough fuel storage space for a fully autonomous voyage of 5,000 nautical miles at a cruising speed of 8.5 knots.

[see more information about M/Y B88 at www.nauyachts.com](http://www.nauyachts.com)

SPECIFICATION

| | |
|--------------------|--------------|
| SHIPYARD, MODEL | Bering B88 |
| BUILT | 2026 |
| LENGTH | 26.2 m |
| WATERLINE LENGTH | 24.8 m |
| HULL CONFIGURATION | DISPLACEMENT |
| BEAM | 8.1 m |
| RANGE | 5000 |
| DRAFT | 2.4 m |
| GROSS TONNAGE | 240 GT |
| YACHT CLASS | RINA |
| CABINS | 5+3 |
| MASTER CABIN | MAIN DECK |
| GUESTS | 10 |
| BERTHS | 10+5 |
| CREW | 5 |
| HEADS | 6+3 |

| | |
|--------------------------------------|----------------------------|
| EXTERIOR DESIGN | SABDES YACHT DESIGN |
| INTERIOR DESIGN | BERING |
| HULL | STEEL |
| SUPERSTRUCTURE | ALUMINIUM |
| ENGINES | 2 x Cummins QSM11 450 h.p. |
| TYPE OF DRIVE | SHAFT LINE |
| ENGINE HOURS | N/A |
| MAXIMUM SPEED | 10.5 kn |
| CRUSING SPEED | 8.5 kn |
| FUEL CONSUMPTION AT ECONOMICAL SPEED | N/A |
| FUEL | 39755 l |
| GREY WATER | 4140 l |
| BLACK WATER | 1800 l |
| FRESH WATER | 2962 l |
| DISPLACEMENT | 225 |

[see more information about M/Y B88 at www.nauyachts.com](http://www.nauyachts.com)



EXTERIOR BERING B88 NEW

M/Y B88



EXTERIOR BERING B88 NEW

M/Y B88



EXTERIOR BERING B88 NEW

M/Y B88



EXTERIOR BERING B88 NEW

M/Y B88



EXTERIOR BERING B88 NEW

M/Y B88



FLYBRIDGE

M/Y B88



BOW LOUNGE AREA

M/Y B88



MAIN SALON LOUNGE AREA

M/Y B88



MAIN SALON LOUNGE AREA

M/Y B88



MAIN SALON DINING AREA

M/Y B88



MAIN SALON DINING AREA

M/Y B88



MAIN DECK STAIRS

M/Y B88



MASTER CABIN

M/Y B88



MASTER CABIN

M/Y B88



MASTER CABIN

M/Y B88



VIP CABIN

M/Y B88



VIP CABIN

M/Y B88



VIP CABIN

M/Y B88

General Arrangement



PROFILE

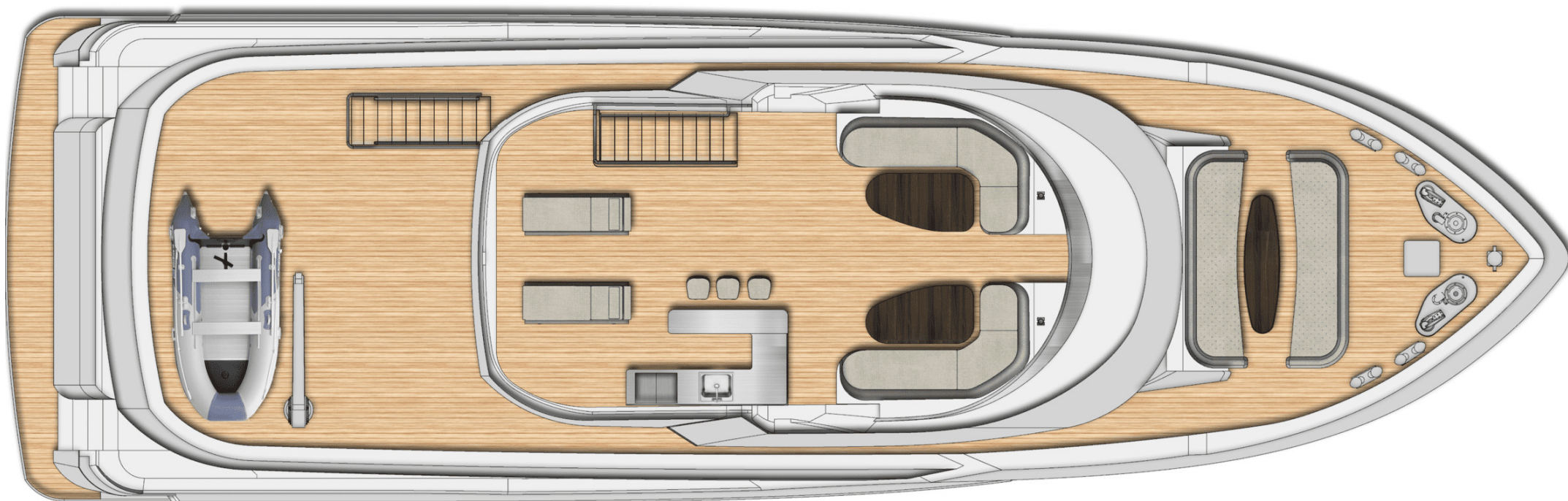

FLYBRIDGE 1

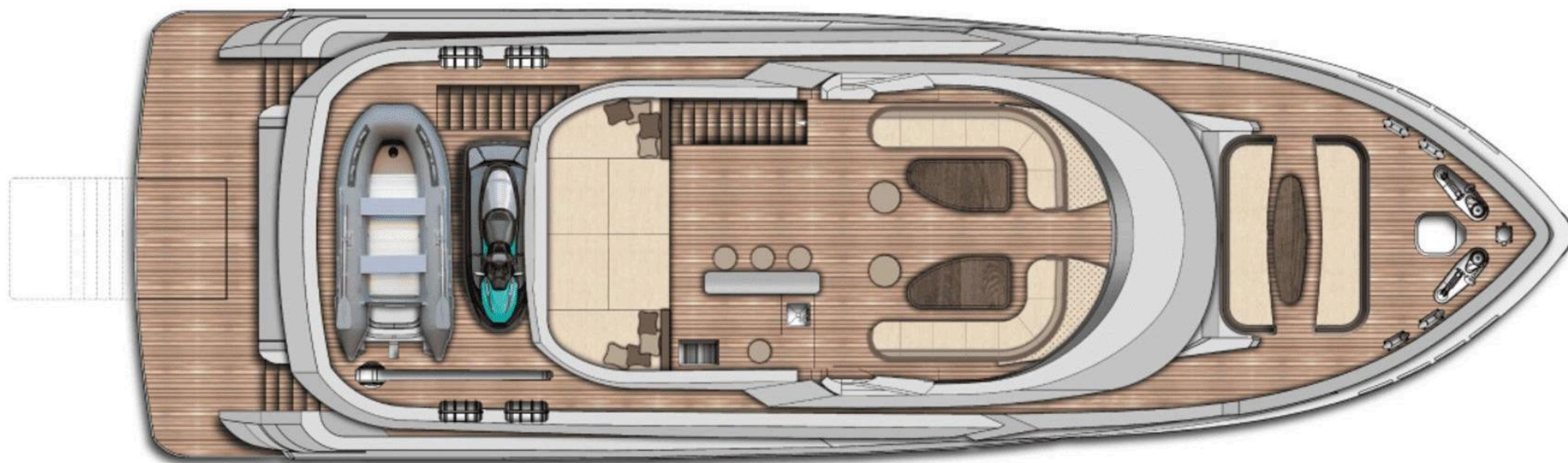

FLYBRIDGE 2

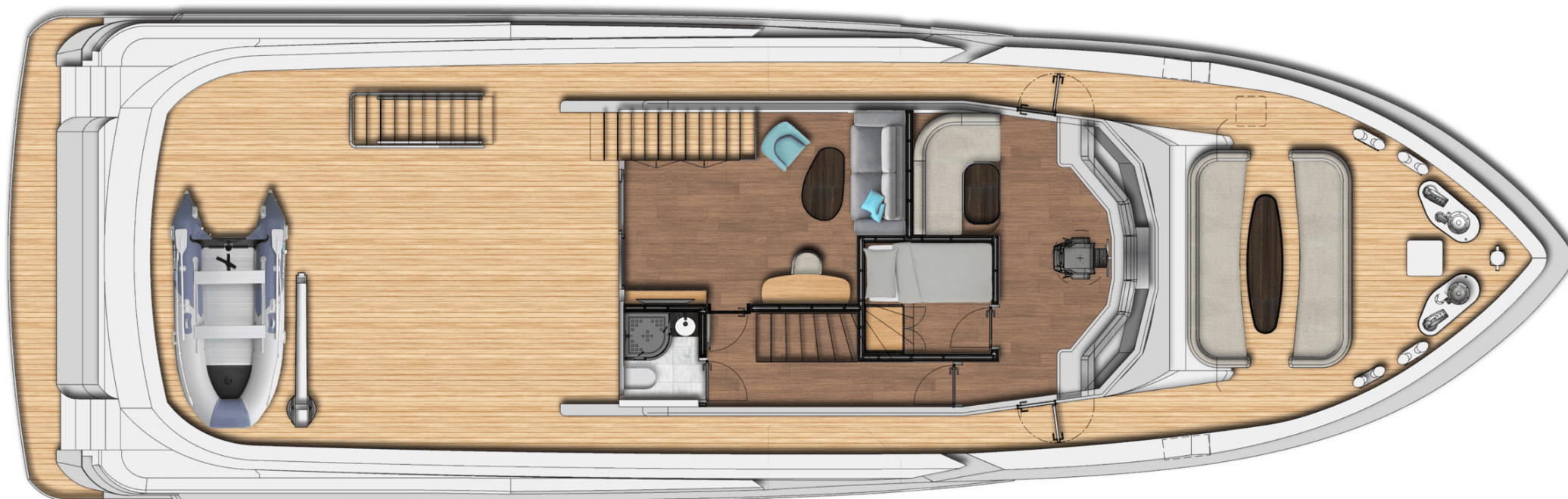

UPPER DECK 1

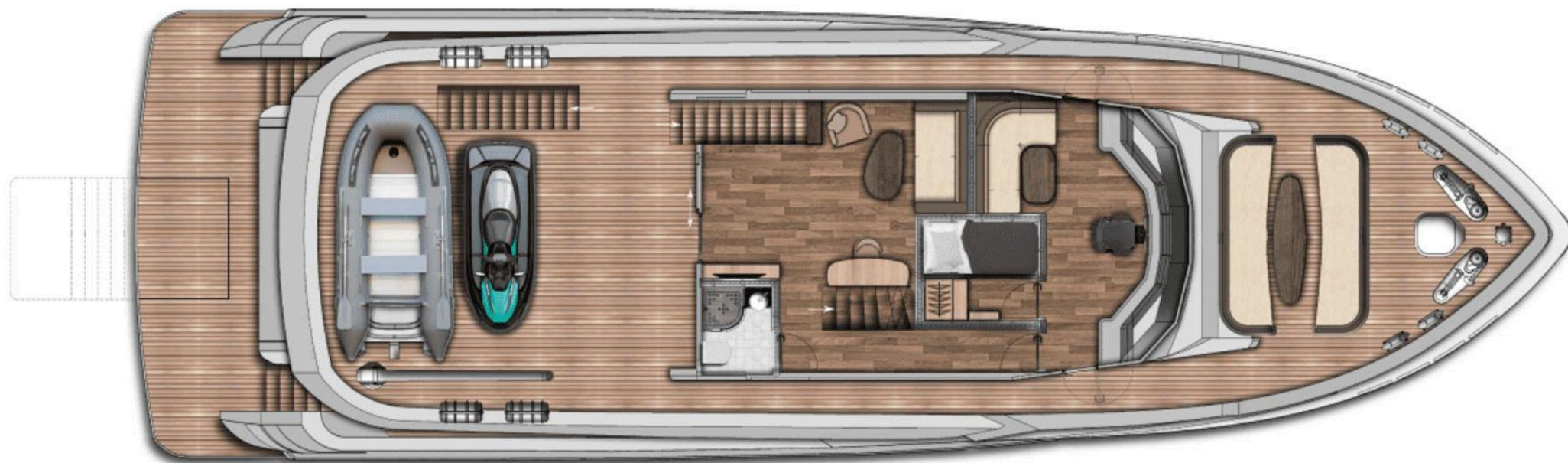

UPPER DECK 2

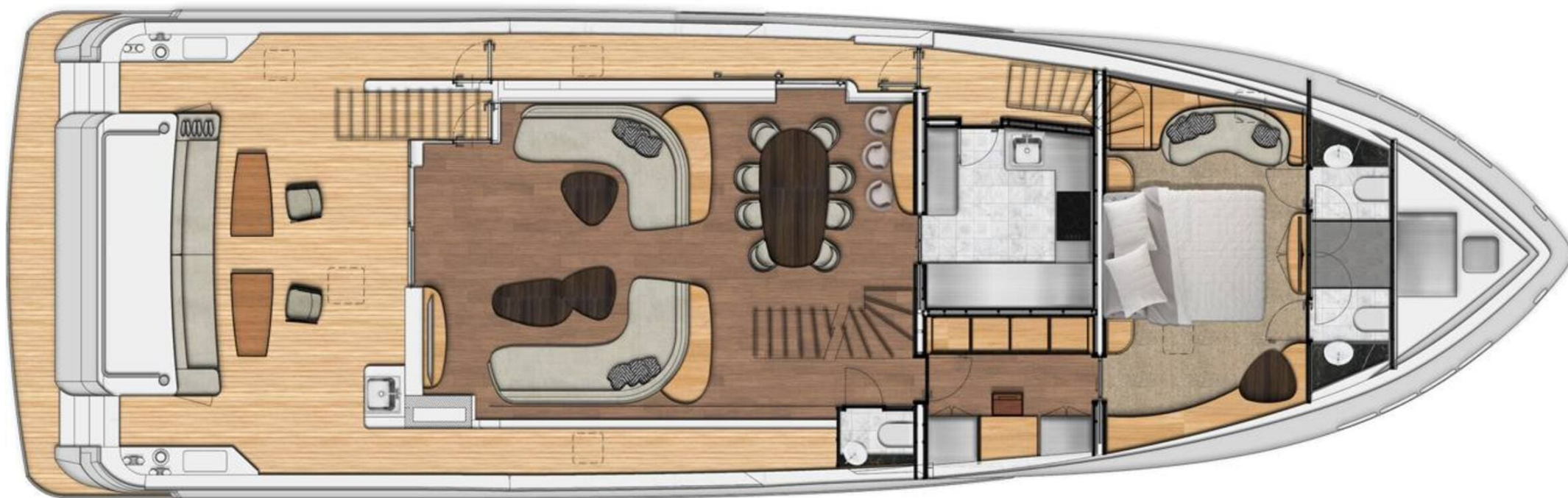

MAIN DECK 1

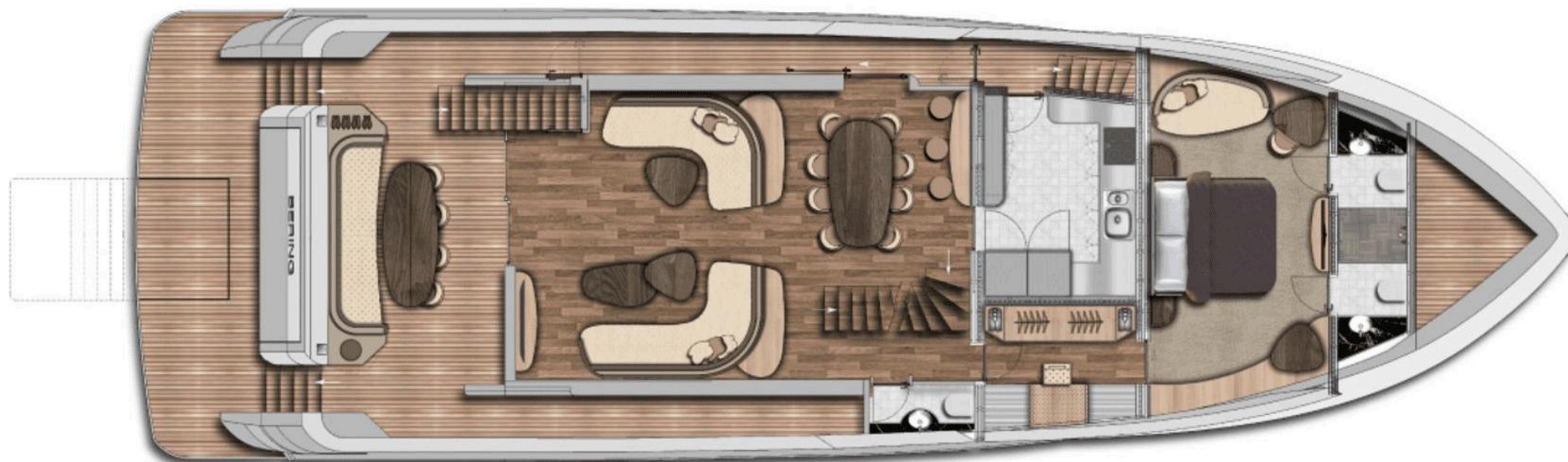

MAIN DECK 2



LOWER DECK 1

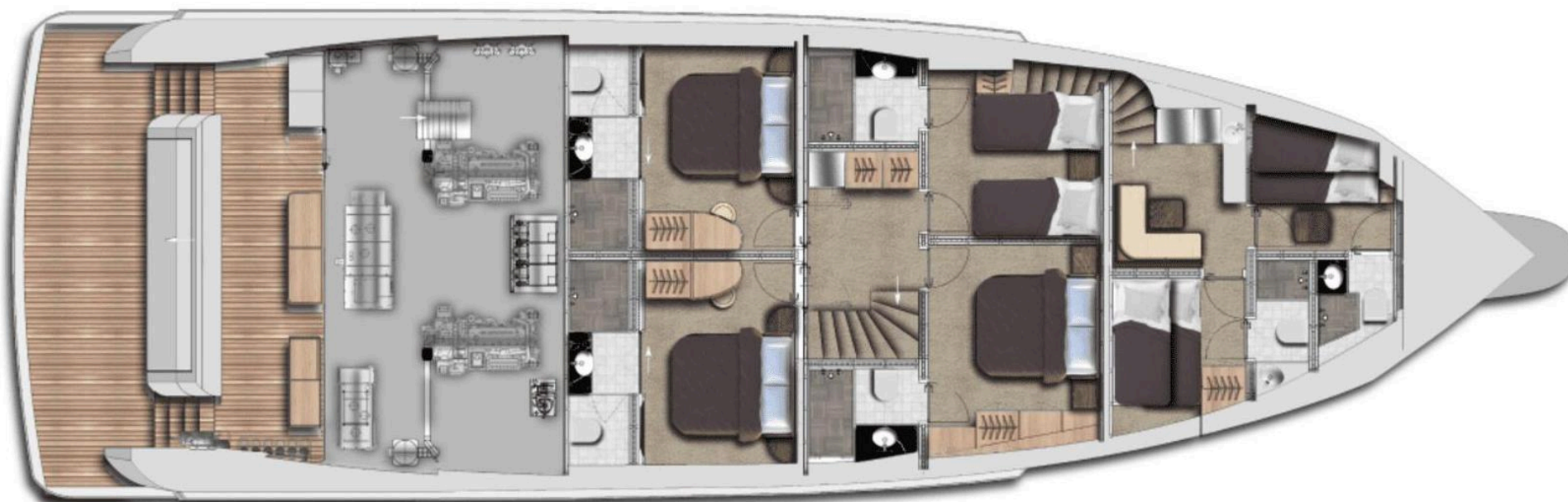

LOWER DECK 2



KIRILL KUATOV

+377 607 93 15 20

+39 333 576 44 44

 [Send e-mail](#)

 WhatsApp

 Telegram